

Your Ultimate Source for OEM Repair Manuals

FactoryManuals.net is a great resource for anyone who wants to save money on repairs by doing their own work. The manuals provide detailed instructions and diagrams that make it easy to understand how to fix a vehicle.

1995 NISSAN Sunny Hatchback OEM Service and Repair Workshop Manual

[Go to manual page](#)

CAUTION:

- Never spill or splash brake fluid on painted surfaces. Brake fluid may seriously damage paint. Wipe it off immediately and wash with water if it gets on a painted surface. For brake component parts, never wash them with water.
- Never depress the brake pedal while removing the brake hose or brake tube. If this is not complied with, brake fluid may splash.
- Never allow foreign matter (e.g. dust) and oils other than brake fluid to enter the reservoir tank.

1 Assemble the union bolt ② and the copper washer to the brake hose ①.

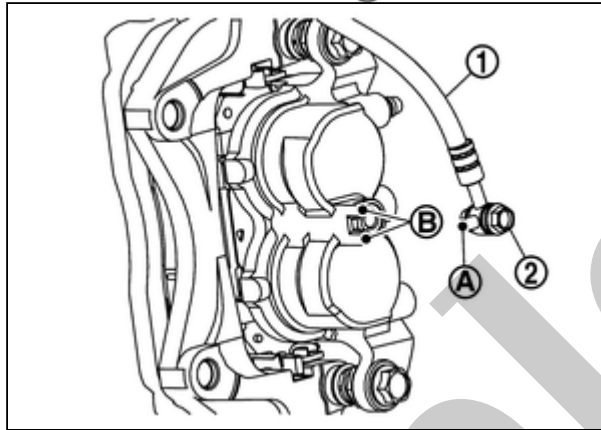

RPR-001824854-03-000353987

CAUTION:

Never reuse the copper washer.

2 Align the brake hose pin (A) with the brake caliper assembly projection (B), and tighten the union bolt to the specified torque.

3 Install the brake tube (2) to the brake hose (1), temporarily tighten the flare nut (3) by hand until it does not rotate further, and fix the brake hose to the bracket (5) with the lock plate (4).

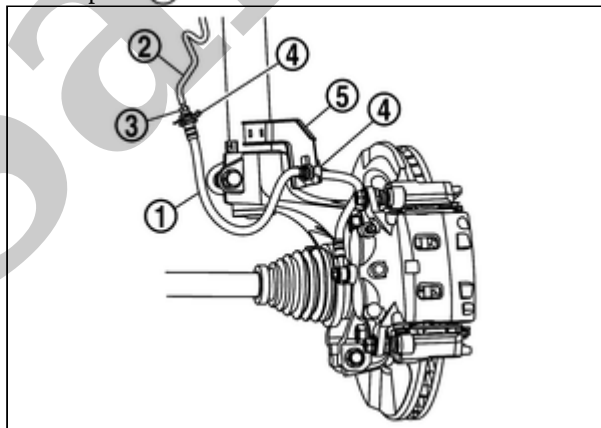

RPR-001824854-02-000353994

CAUTION:

Check that all brake hoses and brake tubes are not twisted and bent.

4 Tighten the flare nut to the specified torque with a flare nut torque wrench (A).

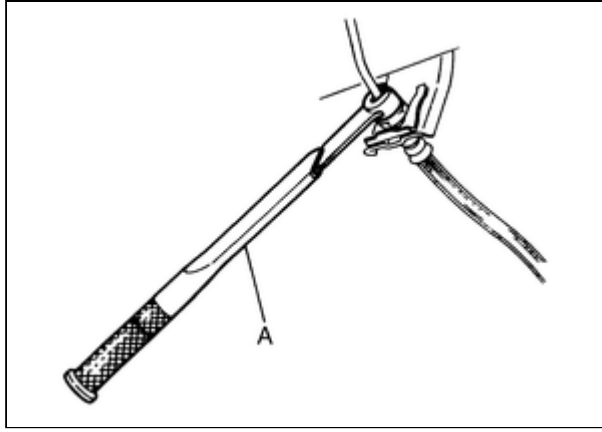

RPR-001824854-04-PFIA0061ZZ

CAUTION:

Never scratch the flare nut and the brake tube.

5 Refill with new brake fluid and perform the air bleeding. Refer to [Bleeding Brake System](#).

CAUTION:

Never reuse drained brake fluid.

6 Install tires. Refer to [Removal and Installation](#).

7 Perform inspection after installation. Refer to [Inspection](#).

Sample

INSPECTION AFTER INSTALLATION

1 Check the brake hoses and tubes for the following: no scratches; no twist and deformation; no interference with other components when steering the steering wheel; no looseness at connections.

CAUTION:

Clearance with brake hose and each parts being secured more than 10 mm (0.39 in) in unladen condition* .

***: Fuel, engine coolant and lubricant are quantity to specified. Spare tire, jack, hand tools and mats are brought out of vehicle.**

2 Depress the brake pedal with a force of 785 N (80 kg, 176 lb) and hold down the pedal for approximately 5 seconds with the engine running. Check for any fluid leakage.

CAUTION:

Retighten the applicable connection to the specified torque and repair any abnormal (damaged, worn or deformed) part if any brake fluid leakage is present.

Sample

REMOVAL

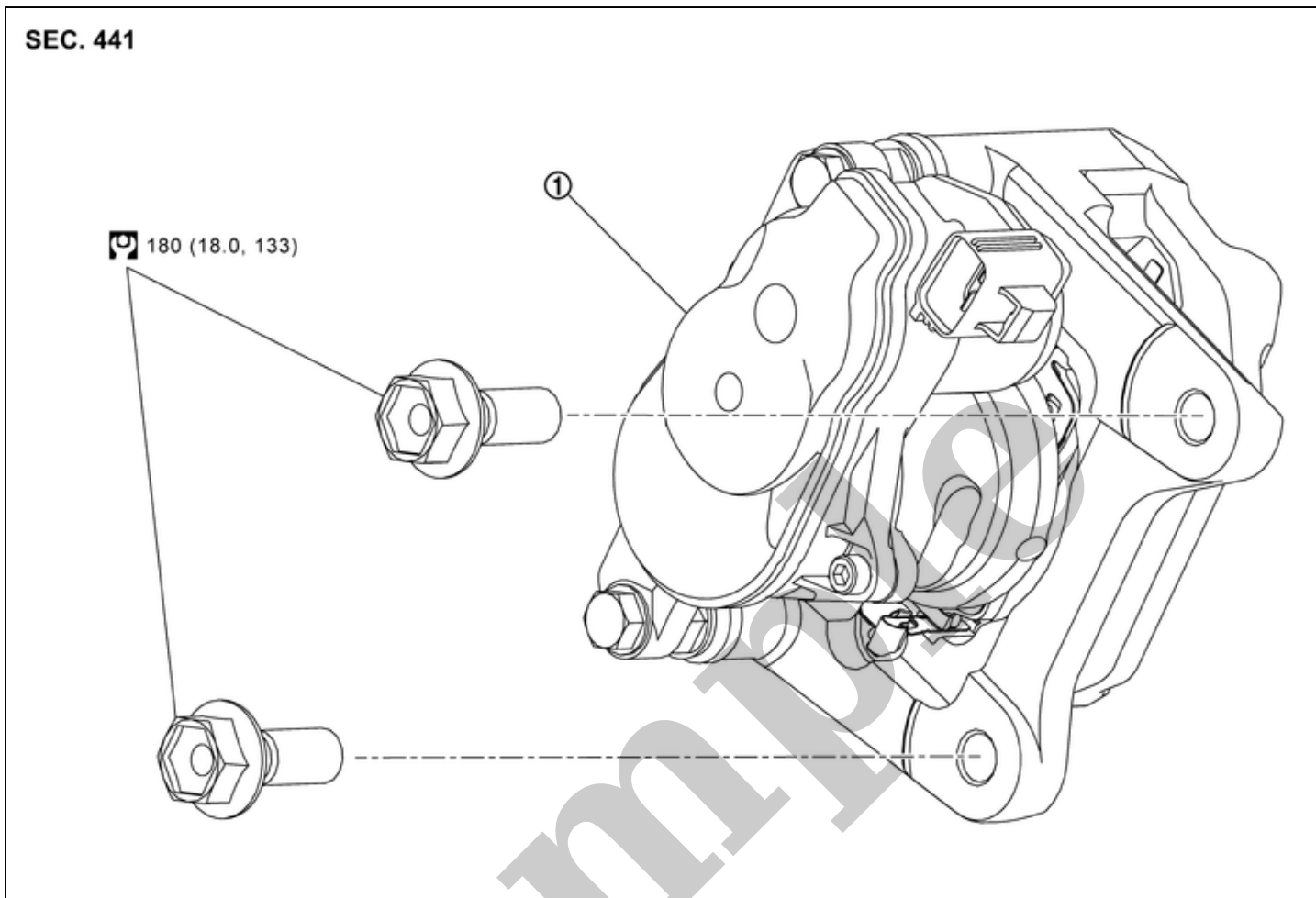

RDE-001824842-01-000347639

| | | | | | |
|---|------------------------|--|--|--|--|
| ① | Brake caliper assembly | | | | |
| 🔧 | : N·m (kg·m, ft·lb) | | | | |

DISASSEMBLY

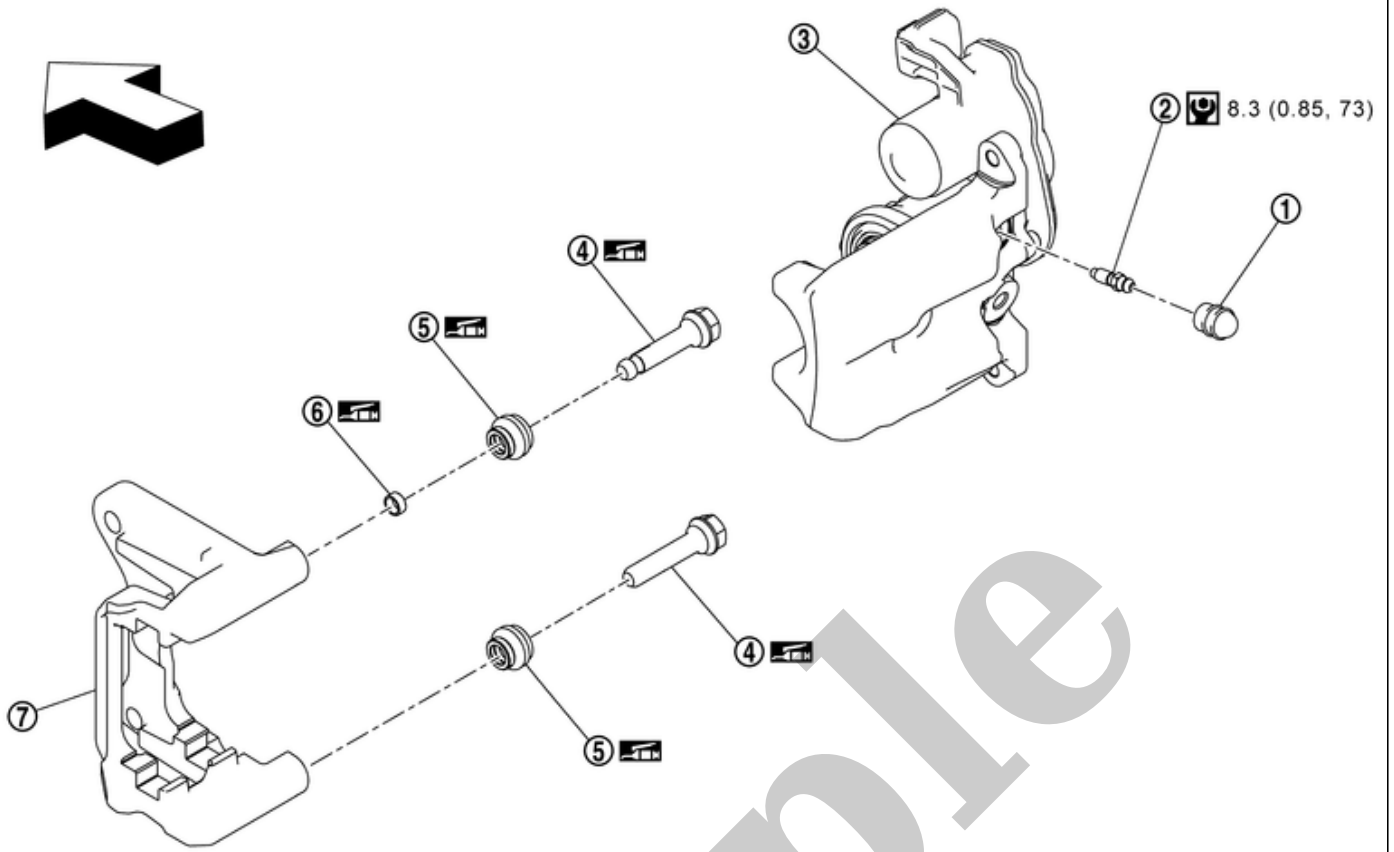

RDE-001824842-02-000347640

| | | | | | |
|---|-------------------------|---|------------------|---|---------------|
| ① | Cap | ② | Bleeder valve | ③ | Cylinder body |
| ④ | Sliding pin | ⑤ | Sliding pin boot | ⑥ | Bushing |
| ⑦ | Torque member | | | | |
| ← | : Vehicle front | | | | |
| ⊗ | : N·m (kg-m, in-lb) | | | | |
| 🔧 | : NISSAN rubber grease. | | | | |

REMOVAL

WARNING:

Remove dust covering brake caliper assembly and brake pad with a dust collector. Never splatter the dust with an air blow gun.

CAUTION:

- Never spill or splash brake fluid on painted surfaces. Brake fluid may seriously damage paint. Wipe it off immediately and wash with water if it gets on a painted surface. For brake component parts, never wash them with water.
- Never drop removed parts.
- Never adhere brake fluid to disc rotor.
- If the brake fluid or grease adheres to disc rotor and cylinder body, quickly wipe it off.

1 Release parking brake.

2 Must be performed additional service when removing and replacing brake pad or rear brake caliper. Refer to [Description](#).

3 Remove tires. Refer to [Removal and Installation](#).

4 Fix disc rotor using wheel nut.

5 Drain brake fluid. Refer to [Draining](#).

6 Separate brake hose from brake caliper assembly. Refer to [Removal and Installation](#).

7 Remove parking brake actuator harness connector (A) and bracket mounting bolt (B).

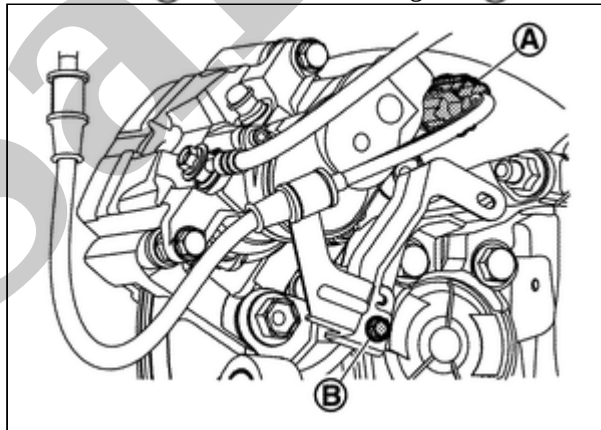

RPR-001824868-04-000366874

8 Remove torque member mounting bolt (A) and then remove brake caliper assembly.

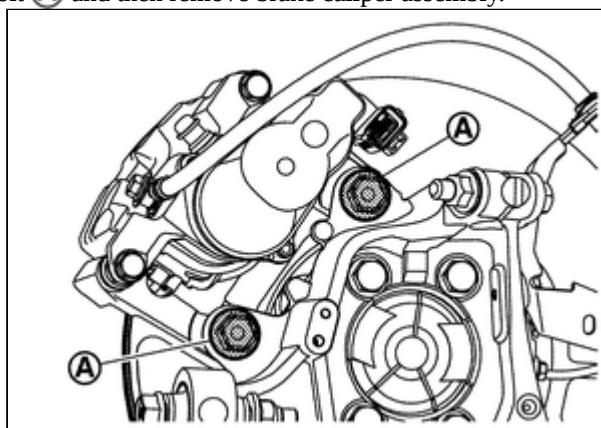

RPR-001824868-01-000366875

INSTALLATION

WARNING:

Remove dust covering brake caliper assembly and brake pad with a dust collector. Never splatter the dust with an air blow gun.

CAUTION:

- Never spill or splash brake fluid on painted surfaces. Brake fluid may seriously damage paint. Wipe it off immediately and wash with water if it gets on a painted surface. For brake component parts, never wash them with water.
- Never depress brake pedal during removal and installation of brake hose because brake fluid may scatter.
- Never adhere brake fluid to disc rotor.
- If the brake fluid or grease adheres to disc rotor and cylinder body, quickly wipe it off.

1 Install disc rotor. Refer to [Removal and Installation](#).

2 Install brake caliper assembly to axle housing and then tighten torque member mounting bolts (A) to the specified torque.

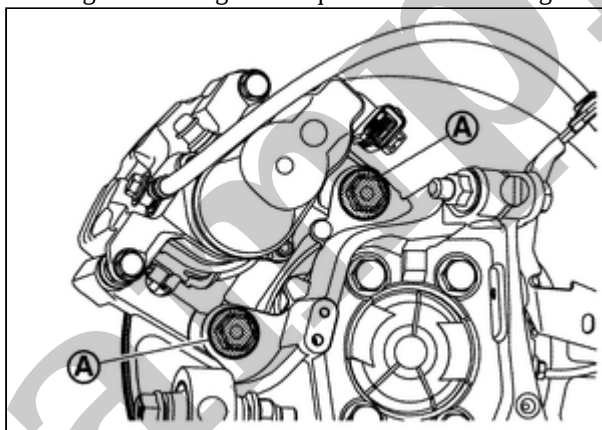

RPR-001824868-03-000366875

CAUTION:

Never spill or splash any grease and moisture on the brake caliper assembly mounting face, threads, mounting bolts and washers. Wipe out any grease and moisture.

3 Install brake hose and copper washers to brake caliper assembly. Refer to [Removal and Installation](#).

CAUTION:

Never reuse copper washer.

4 Install parking brake actuator harness connector (A) and bracket mounting bolt (B).

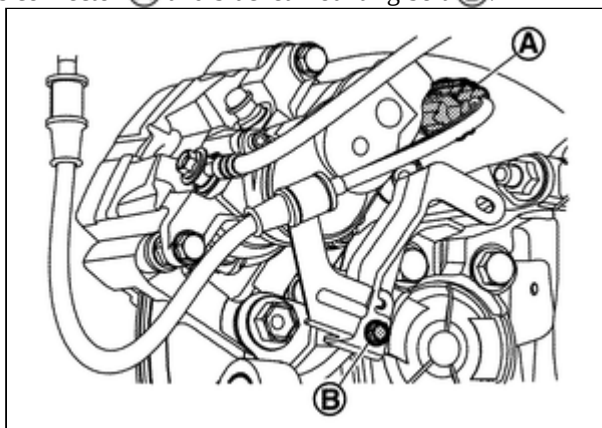

RPR-001824868-02-000366874

a Must be performed additional service when removing and replacing brake pad or brake caliper. Refer to [Description](#).

5 Perform air bleeding. Refer to [Bleeding](#).

6 Check drag of rear disc brake. If any drag is felt. Refer to [Inspection](#).

7 Install tires. Refer to [Removal and Installation](#).

8 Perform inspection after installation. Refer to [Inspection](#).

Sample

DISASSEMBLY

CAUTION:
Never drop parts.



NOTE:

Never remove the torque member, brake pad and pad retainer when disassembling cylinder body.

1 Remove sliding pin bolt, and then remove cylinder body from torque member. Refer to [Removal and Installation](#).

CAUTION:

Fix brake pad with suitable tape to prevent brake pad from dropping.

2 Remove sliding pins and sliding pin boots from torque member.

3 Remove bushing ① from sliding pin ②.

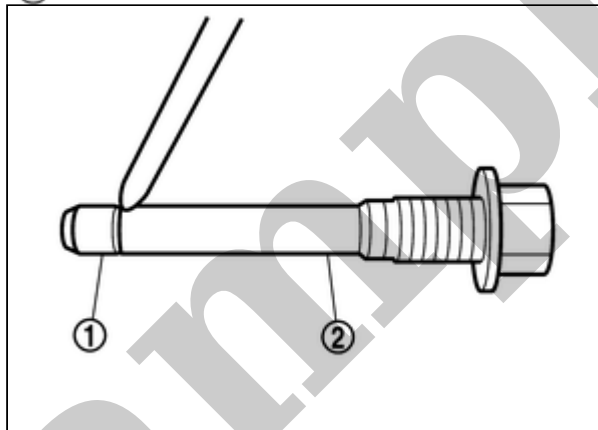

RPR-001824866-01-SFIA0496ZZ

4 Remove bleeder valve and cap.

5 Perform inspection after disassembly. Refer to [Inspection](#).

ASSEMBLY

1 Install bleeder valve and cap.

2 Apply rubber grease to mating faces (A) between sliding pin bolt ① and bushing ②, and install bushing to sliding pin.

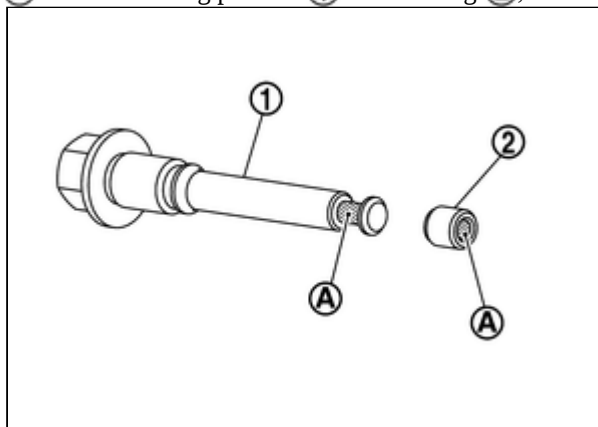

RPR-001824866-02-SFIA0497ZZ

3 Apply Nissan rubber grease to mating faces (A) between sliding pins ① and sliding pin boots ②, and then install sliding pins and sliding pin boots to torque member ③.