

# Your Ultimate Source for OEM Repair Manuals

FactoryManuals.net is a great resource for anyone who wants to save money on repairs by doing their own work. The manuals provide detailed instructions and diagrams that make it easy to understand how to fix a vehicle.

## 1995 NISSAN Sunny 3 Doors OEM Service and Repair Workshop Manual

[Go to manual page](#)

# REAR BRAKE PIPING : Hydraulic Layout

RDE-001824847

## SEC.462

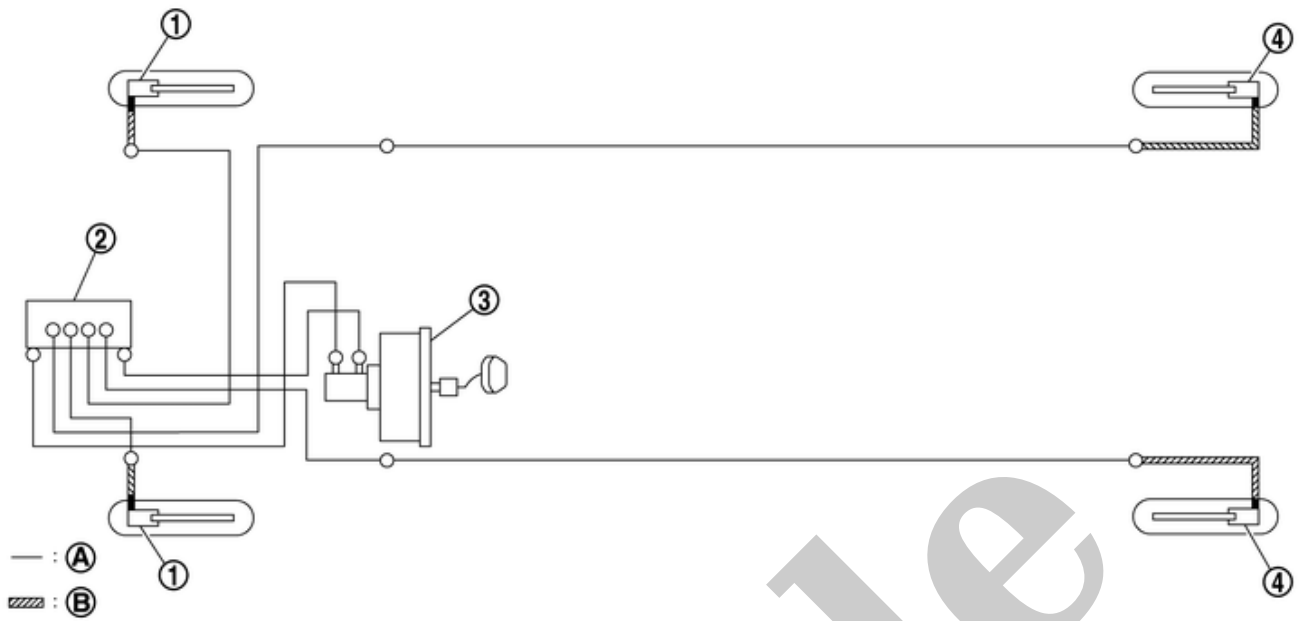

RDE-001824847-01-000378576

①	Front disc brake	②	ABS actuator and electric unit (control unit)	③	Electrically-driven intelligent brake unit
④	Rear disc brake				
(A)	Brake tube	(B)	Brake hose		
○	: Flare nut				
■	: Union bolt				

## REMOVAL

### CAUTION:

- Never spill or splash brake fluid on painted surfaces. Brake fluid may seriously damage paint. Wipe it off immediately and wash with water if it gets on a painted surface. For brake component parts, never wash them with water.
- Never depress the brake pedal while removing the brake hose or brake tube. If this is not complied with, brake fluid may splash.
- Wipe off immediately when attaching brake fluid with disc rotor and caliper assembly.

1 Remove tires. Refer to [Removal and Installation](#).

2 Remove the lock plate (4), then remove the brake hose from the brake tube bracket.

3 Loosen the flare nut (1) with a flare nut wrench (A) and separate the brake tube (2) from the brake hose (3).

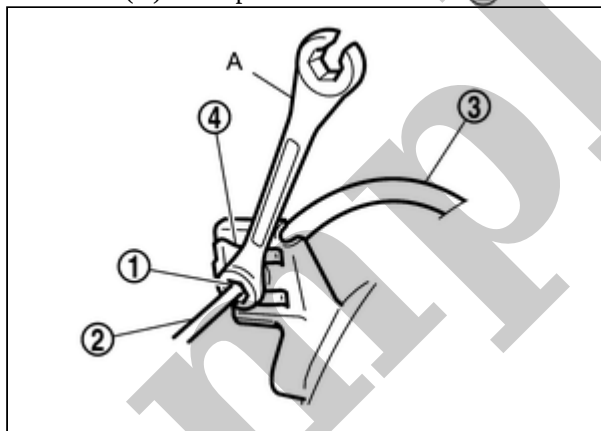

RPR-001824841-02-000313289

### CAUTION:

- Never scratch the flare nut and the brake tube.
- Never bend sharply, twist or strongly pull out the brake hoses and tubes.
- Cover open end of brake tubes and brake hoses when disconnecting to prevent entrance of dirt.

4 Remove the lock plate (4), then remove the brake tube B (2) from the brake tube bracket.

5 Remove the union bolt (1) and aluminum washers (2), and remove the brake hose (3) from the brake caliper assembly.

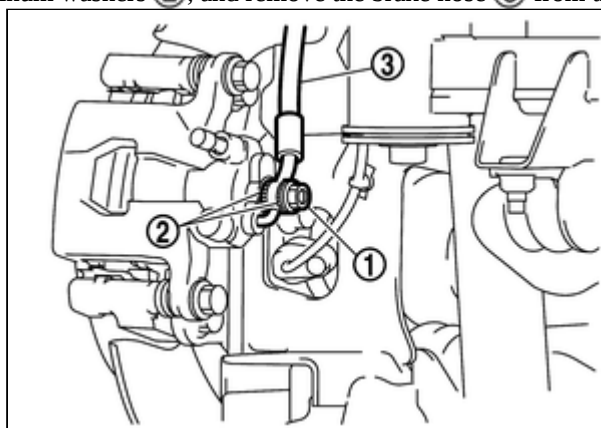

RPR-001824841-03-SFIA0471ZZ

# INSTALLATION

## CAUTION:

- Never spill or splash brake fluid on painted surfaces. Brake fluid may seriously damage paint. Wipe it off immediately and wash with water if it gets on a painted surface. For brake component parts, never wash them with water.
- Never depress the brake pedal while removing the brake hose or brake tube. If this is not complied with, brake fluid may splash.
- Never allow foreign matter (e.g. dust) and oils other than brake fluid to enter the reservoir tank.
- Wipe off immediately when attaching brake fluid with disc rotor and caliper assembly.

1 Assemble the union bolt ① and the aluminum washers ② to the brake hose.

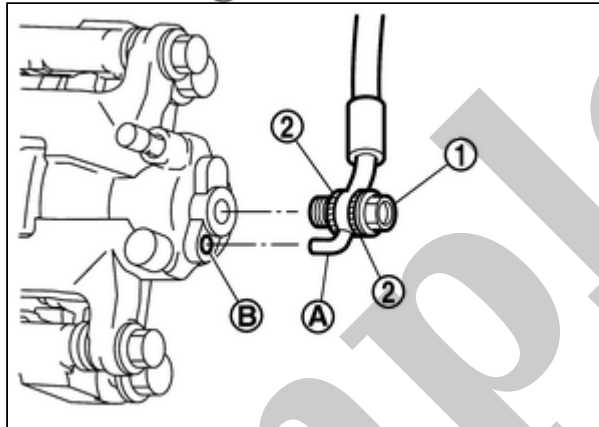

RPR-001824841-04-SFIA0472ZZ

## CAUTION:

Never reuse the aluminum washer.

2 Align the brake hose L-pin ① with the brake caliper assembly hole ②, and tighten the union bolt to the specified torque.

3 Install the brake hose to the brake tube, temporarily tighten the flare nut by hand until it does not rotate further, and fix the brake hose to the brake hose bracket with the lock plate.

## CAUTION:

Check that all brake hoses and brake tubes are not twisted and bent.

4 Tighten the flare nut to the specified torque with a flare nut torque wrench (A).

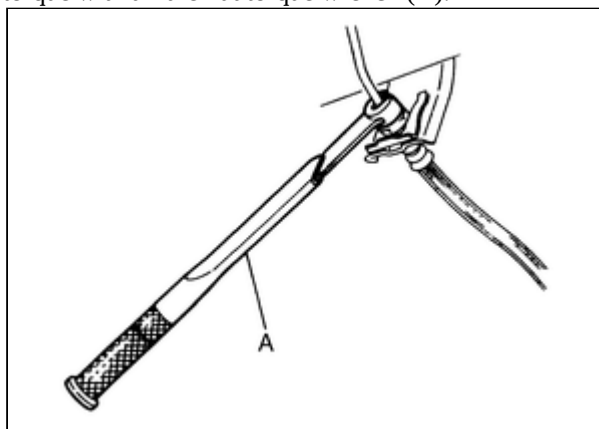

RPR-001824841-06-PFIA0061ZZ

## CAUTION:

Never scratch the flare nut and the brake tube.

5 Refill with new brake fluid and perform the air bleeding. Refer to [Bleeding Brake System](#).

**CAUTION:**

**Never reuse drained brake fluid.**

6 Install tires. Refer to [Removal and Installation](#).

7 Perform inspection after installation. Refer to [Inspection](#).

Sample

## INSPECTION AFTER INSTALLATION

---

1 Check the brake hoses and tubes for the following: no scratches; no twist and deformation; no looseness at connections.

**CAUTION:**

**Clearance with brake hose and each parts being secured more than 10 mm (0.39 in) in unladen condition\* .**

**\*: Fuel, engine coolant and lubricant are quantity to specified. Spare tire, jack, hand tools and mats are brought out of vehicle.**

2 Depress the brake pedal with a force of 785 N (80 kg, 176 lb) and hold down the pedal for approximately 5 seconds with the engine running. Check for any fluid leakage.

**CAUTION:**

**Retighten the applicable connection to the specified torque and repair any abnormal (damaged, worn or deformed) part if any brake fluid leakage is present.**

Sample

# FRONT BRAKE PIPING : Exploded View



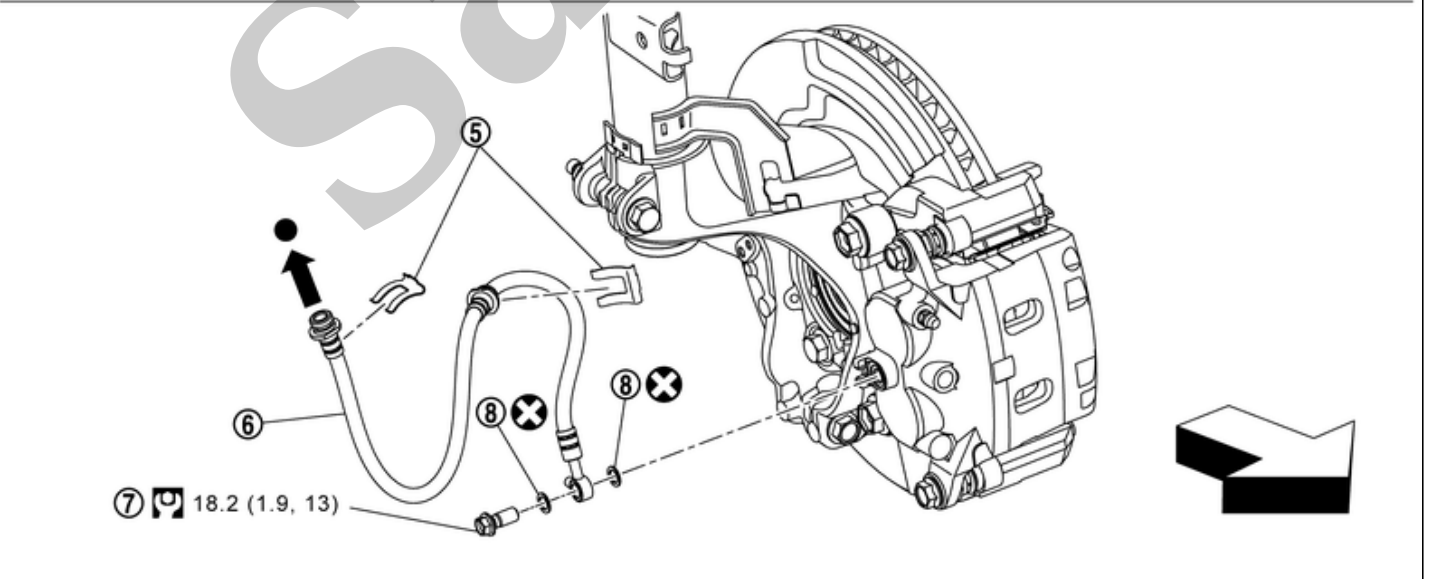
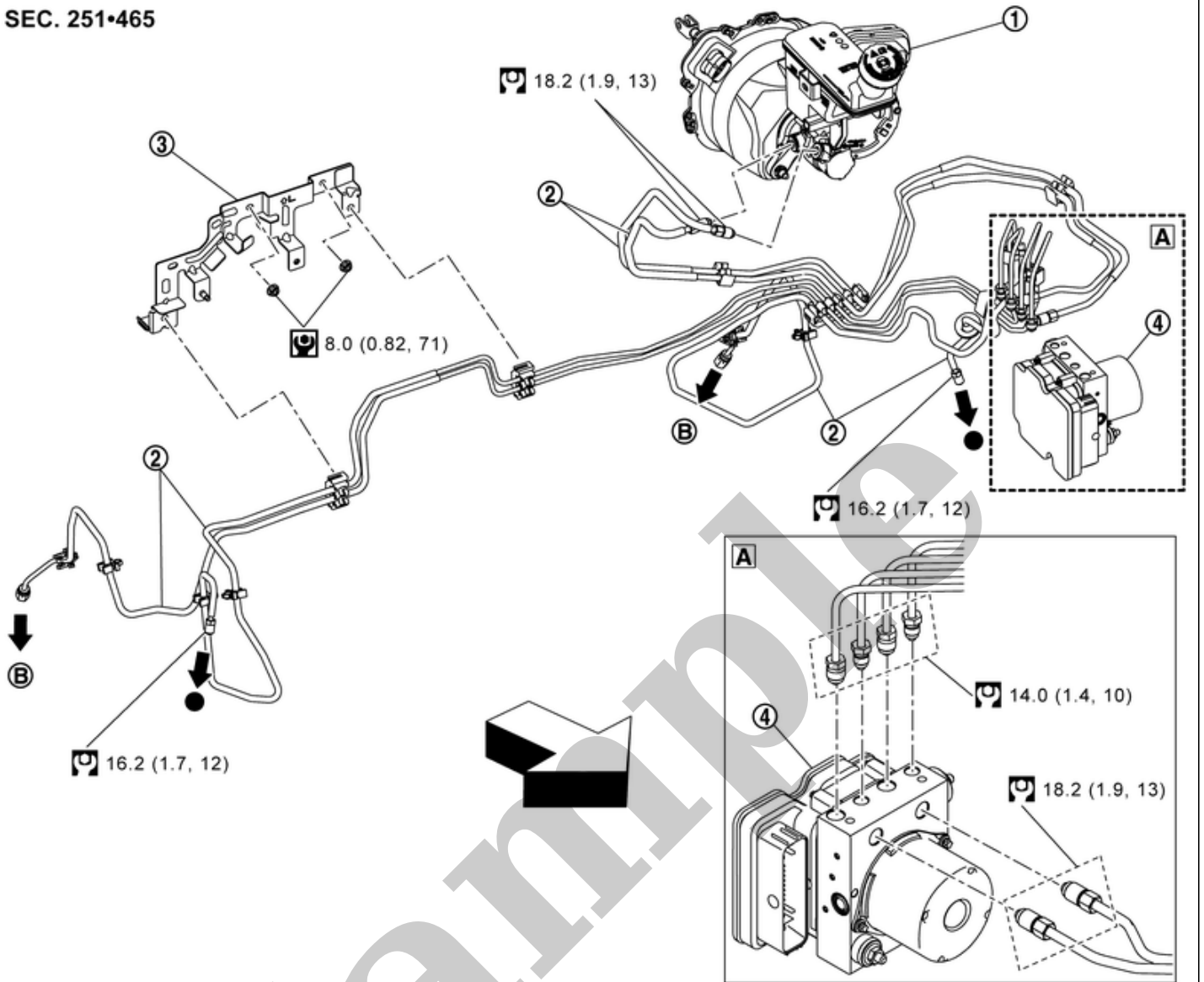

RDE-001824840

SEC. 251•465



RDE-001824840-01-000372381

①	electrically-driven intelligent brake unit	②	Brake tube	③	Bracket
④	ABS actuator and electric unit (control unit)	⑤	Lock plate	⑥	Brake hose
⑦	Union bolt	⑧	Copper washer		
Ⓑ	To rear brake tube. Refer to <a href="#">Exploded View</a> .				

	: Vehicle front
	: N·m (kg-m, ft-lb)
	: N·m (kg-m, in-lb)
	: Always replace after every disassembly.
	: Indicates that the part is connected at points with same symbol in actual vehicle.

Sample



# FRONT BRAKE PIPING : Hydraulic Layout

RDE-001824845

## SEC.462

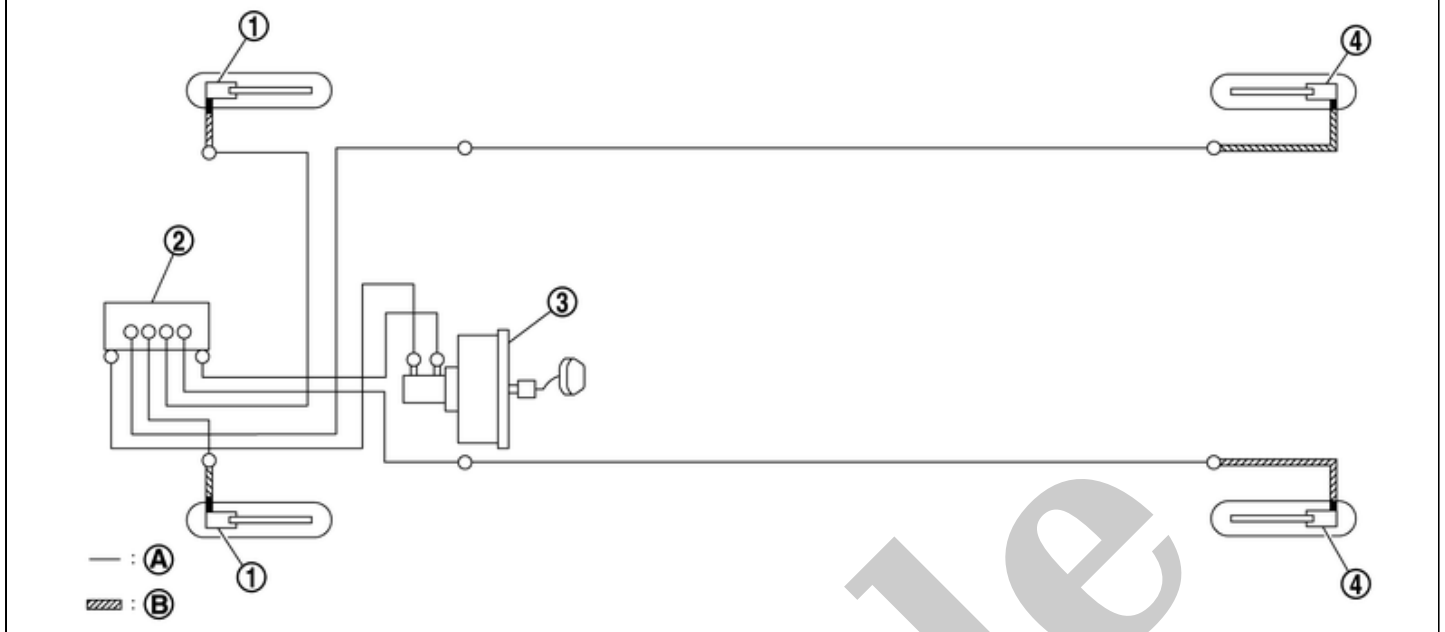

RDE-001824845-01-000378576

①	Front disc brake	②	ABS actuator and electric unit (control unit)	③	Electrically-driven intelligent brake unit
④	Rear disc brake				
(A)	Brake tube	(B)	Brake hose		
○	: Flare nut				
■	: Union bolt				

## REMOVAL

### CAUTION:

- Never spill or splash brake fluid on painted surfaces. Brake fluid may seriously damage paint. Wipe it off immediately and wash with water if it gets on a painted surface. For brake component parts, never wash them with water.
- Never depress the brake pedal while removing the brake hose or brake tube. If this is not complied with, brake fluid may splash.

1 Remove tires. Refer to [Removal and Installation](#).

2 Drain brake fluid. Refer to [Draining](#).

3 Loosen the flare nut ① with a flare nut wrench (A) and separate the brake tube ② from the brake hose ③.

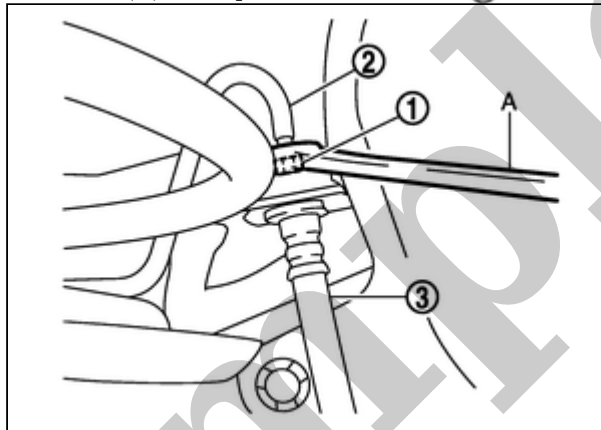

RPR-001824854-01-PFIA0847ZZ

### CAUTION:

- Never scratch the flare nut and the brake tube.
- Never bend sharply, twist or strongly pull out the brake hoses and tubes.
- Cover open end of brake tubes and hoses when disconnecting to prevent entrance of dirt.

4 Remove the union bolt ① and copper washers ②, and remove the brake hose ③ from the brake caliper assembly.

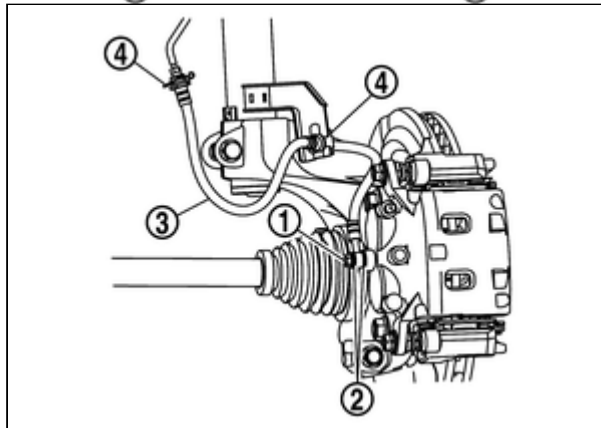

RPR-001824854-05-000347629

5 Remove the lock plate ④ and remove the brake hose.

## INSTALLATION