

Your Ultimate Source for OEM Repair Manuals

FactoryManuals.net is a great resource for anyone who wants to save money on repairs by doing their own work. The manuals provide detailed instructions and diagrams that make it easy to understand how to fix a vehicle.

1994 VOLVO 940 OEM Service and Repair Workshop Manual

[Go to manual page](#)

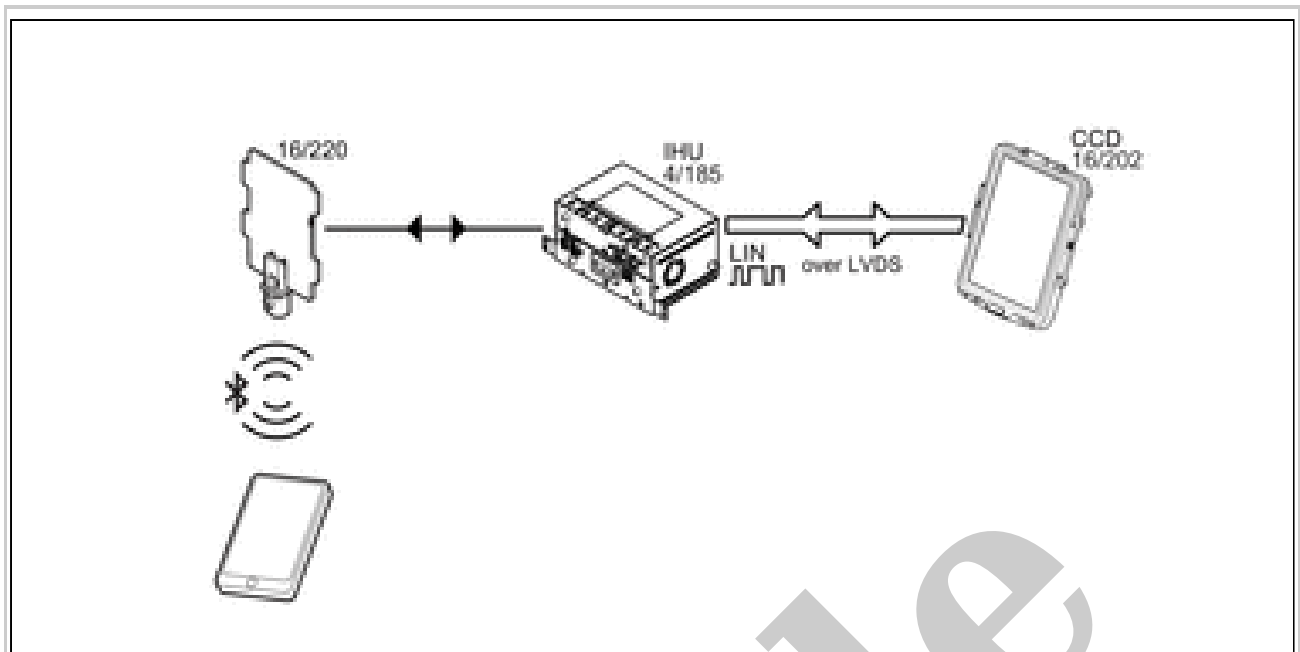

Courtesy of VOLVO CARS CORPORATION

The table below summarizes input and output signals to and from the Infotainment Head Unit (IHU).

Input signals	Output signals
Directly connected Bluetooth signal: <ul style="list-style-type: none"> Bluetooth antenna (16/220) 	Directly connected Bluetooth signal: <ul style="list-style-type: none"> Bluetooth antenna (16/220)
LIN over LVDS Input information: <ul style="list-style-type: none"> Center Console Display (CCD) (16/202) 	LIN over LVDS Message display: <ul style="list-style-type: none"> Center Console Display (CCD) (16/202)

SENSUS: RADIO > SENSUS: RADIO [2018-2022] > DESCRIPTION

The radio function handles the reception and playback of:

- AM/FM radio
- HD radio
- DAB radio
- Sirius XM Satellite Radio

The Infotainment Head Unit (IHU) controls the function based on settings made in the Center Console Display (CCD).

SENSUS: RADIO > SENSUS: RADIO [2018-2022] > VARIANTS

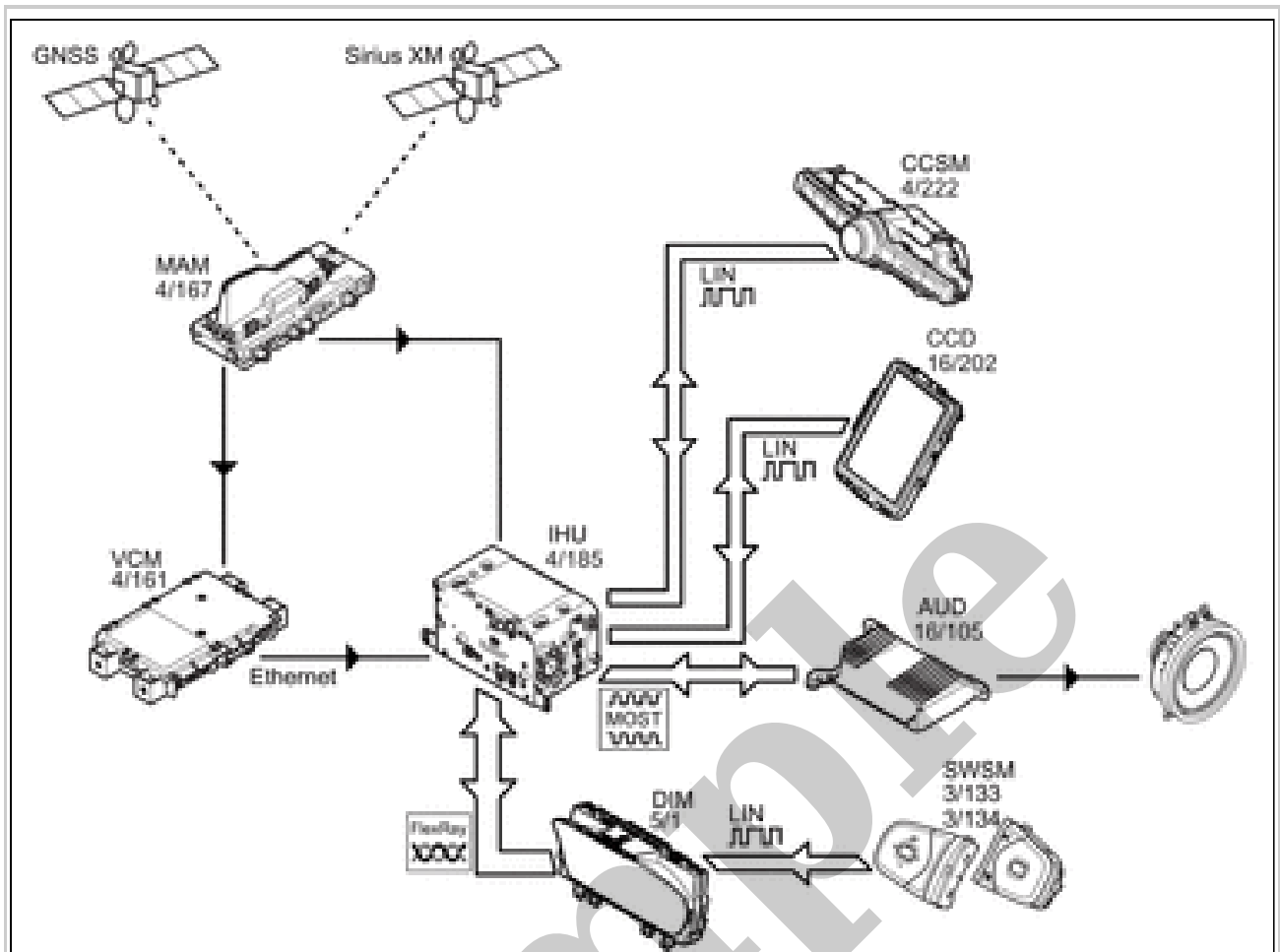

Courtesy of VOLVO CARS CORPORATION

The table below summarizes input and output signals to and from the Infotainment Head Unit (IHU)

Input signals	Output signals
Directly connected Satellite radio signal: <ul style="list-style-type: none"> Multiband antenna module (MAM) (4/167) 	Directly connected
Ethernet GNSS data: <ul style="list-style-type: none"> Multiband antenna module (MAM) (4/167) via - Vehicle Connectivity Module (VCM) (4/161) 	Ethernet
LIN Control of satellite radio: <ul style="list-style-type: none"> Center console switch module CCSM (4/222) 	LIN
LIN over LVDS Control of satellite radio:	LIN over LVDS Information displayed in the satellite radio

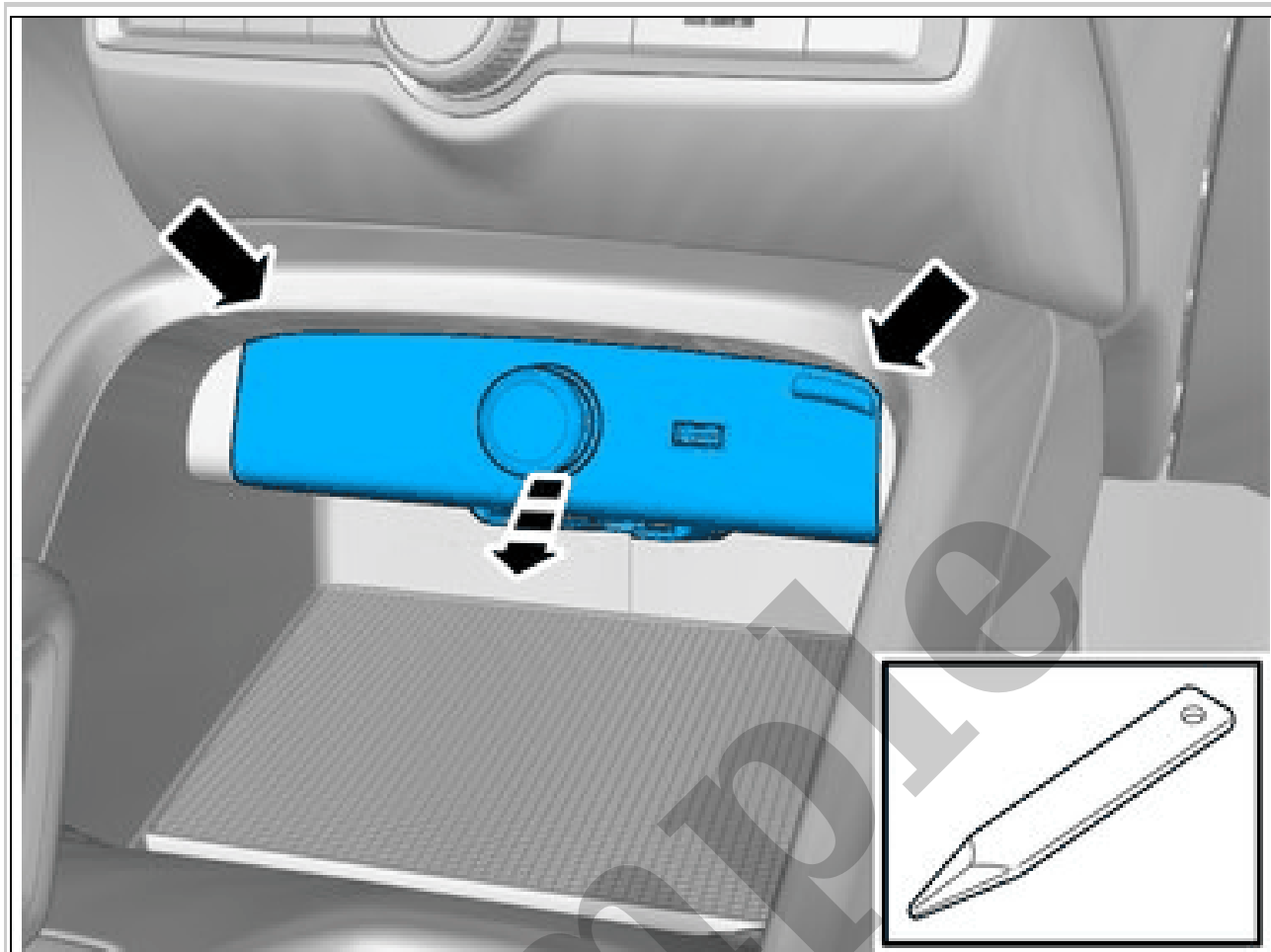

Courtesy of VOLVO CARS CORPORATION

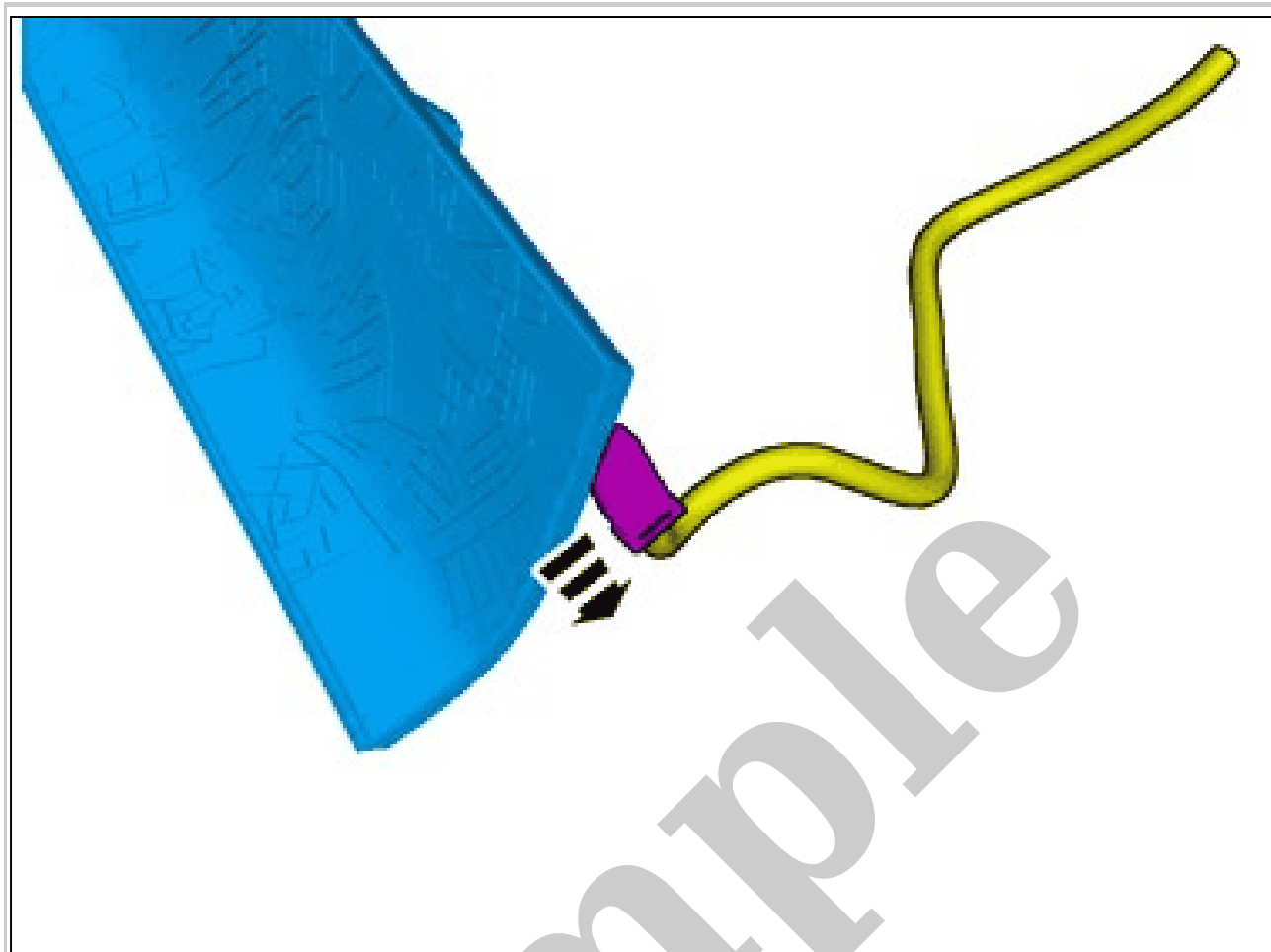

Courtesy of VOLVO CARS CORPORATION

Disconnect the connector.

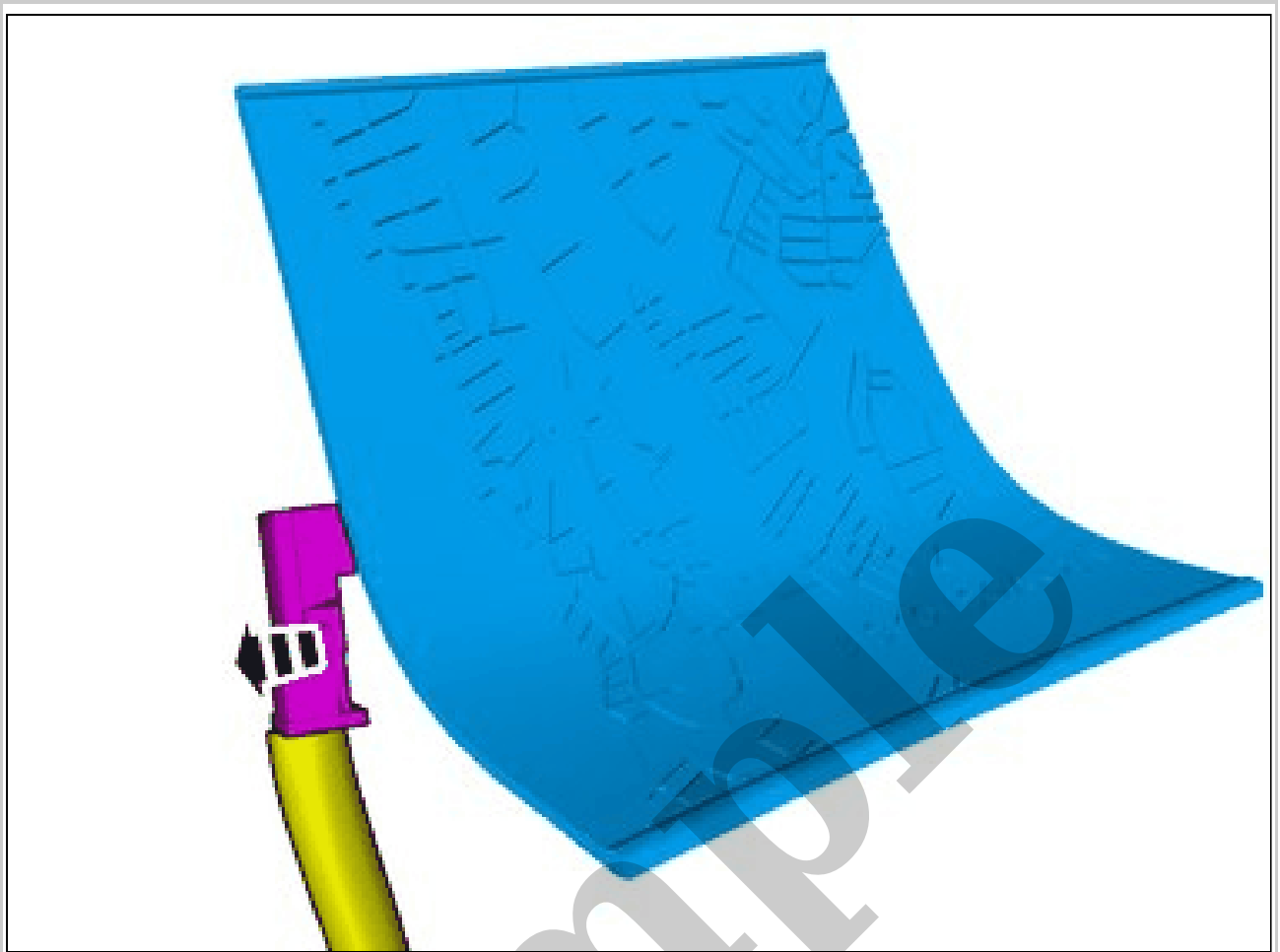

Courtesy of VOLVO CARS CORPORATION

Disconnect the connector.

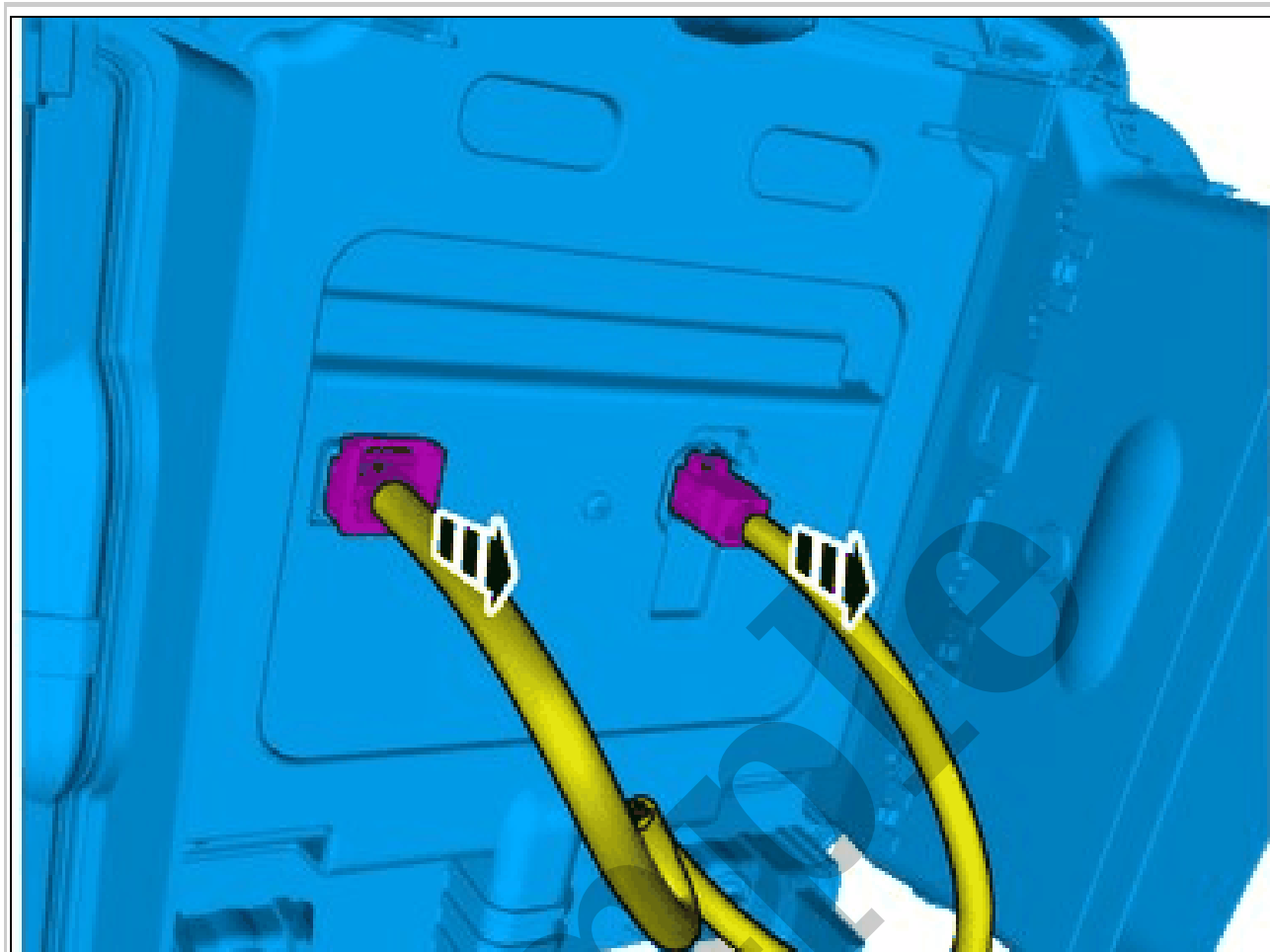

Courtesy of VOLVO CARS CORPORATION

Disconnect the connectors.

NOTE: Removal steps in this procedure may contain installation details.

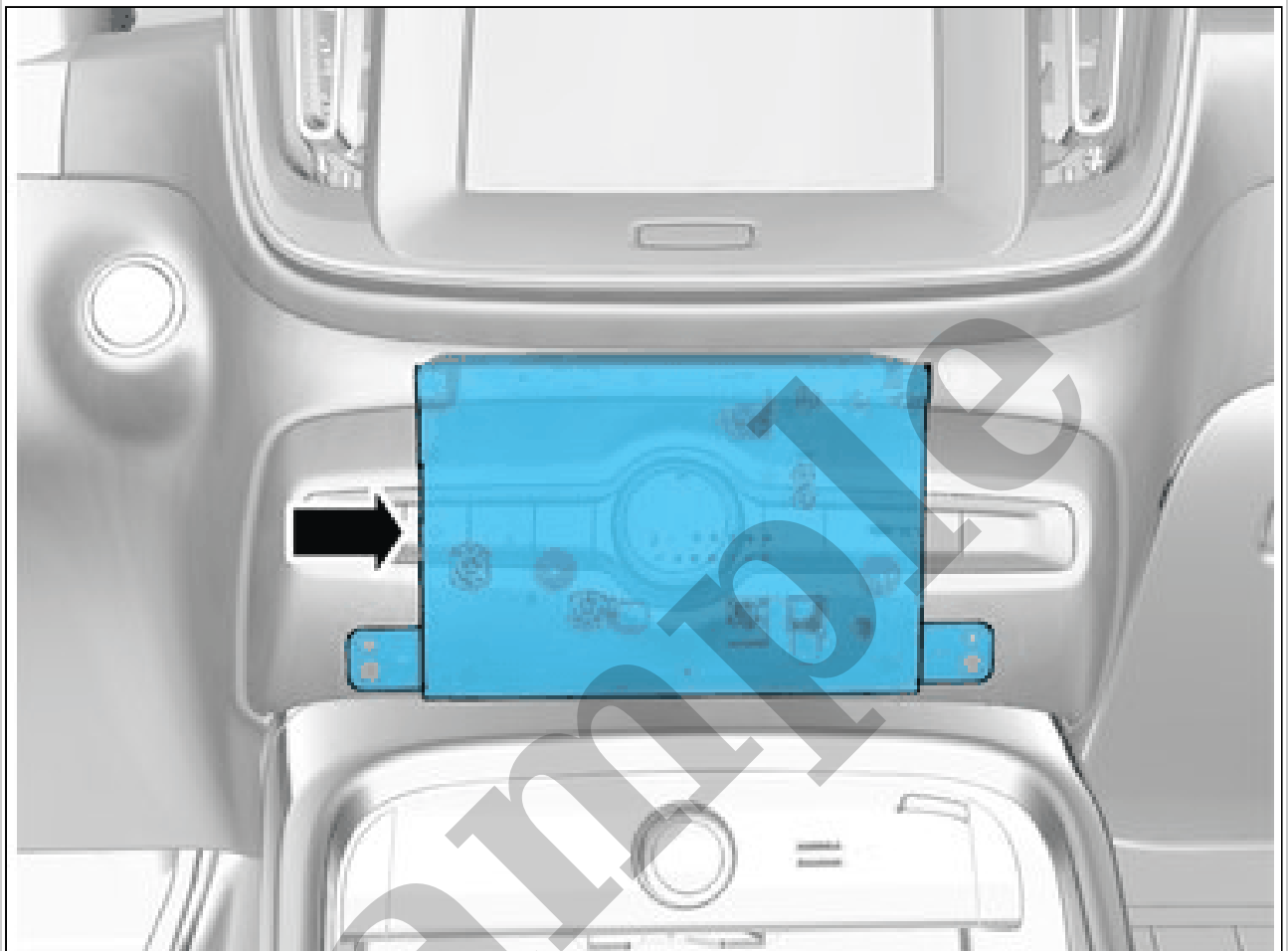

Courtesy of VOLVO CARS CORPORATION

NOTE: Orientation view

NOTE: The following steps are only necessary when installing a new component.

Follow instructions regarding managing customer profiles. Refer to: HANDLING CUSTOMER PROFILES

NOTE: The following items must always be performed

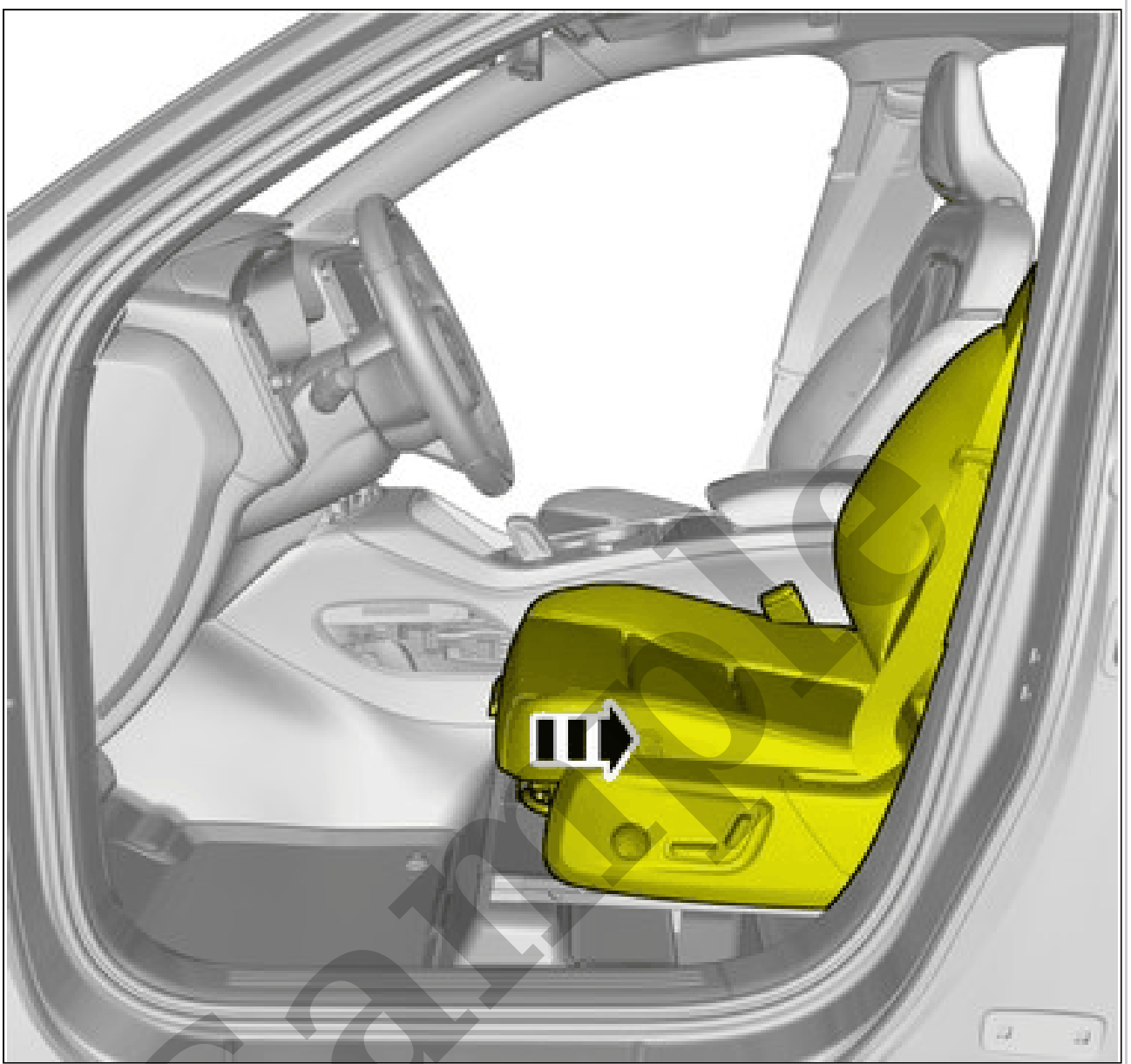

Courtesy of VOLVO CARS CORPORATION

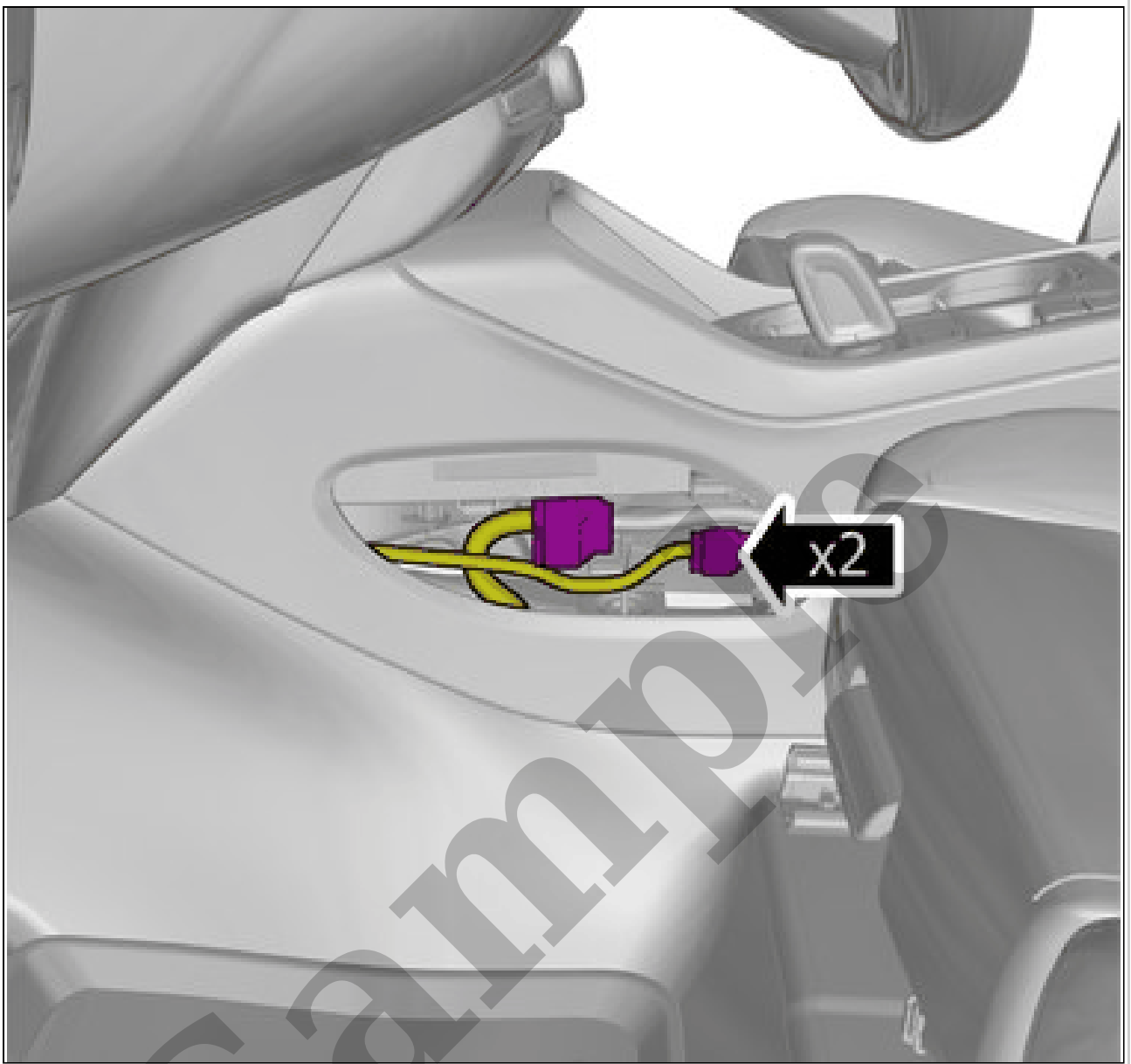

Courtesy of VOLVO CARS CORPORATION

Disconnect the connectors.