

Your Ultimate Source for OEM Repair Manuals

FactoryManuals.net is a great resource for anyone who wants to save money on repairs by doing their own work. The manuals provide detailed instructions and diagrams that make it easy to understand how to fix a vehicle.

1993 FORD Sierra 3 Doors OEM Service and Repair Workshop Manual

[Go to manual page](#)

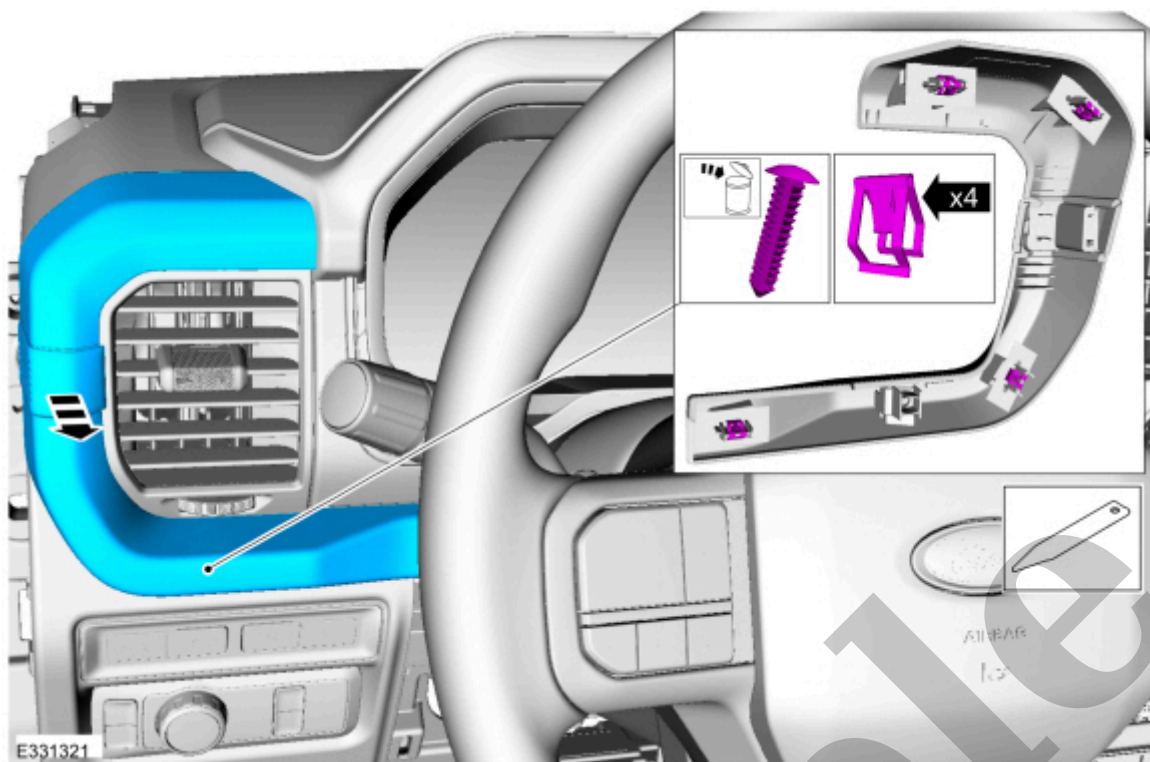

[Click here to learn about symbols, color coding, and icons used in this manual.](#)

4. Release the clips and remove the lower steering column closeout panel.

Remove the General Equipment: Interior Trim Remover

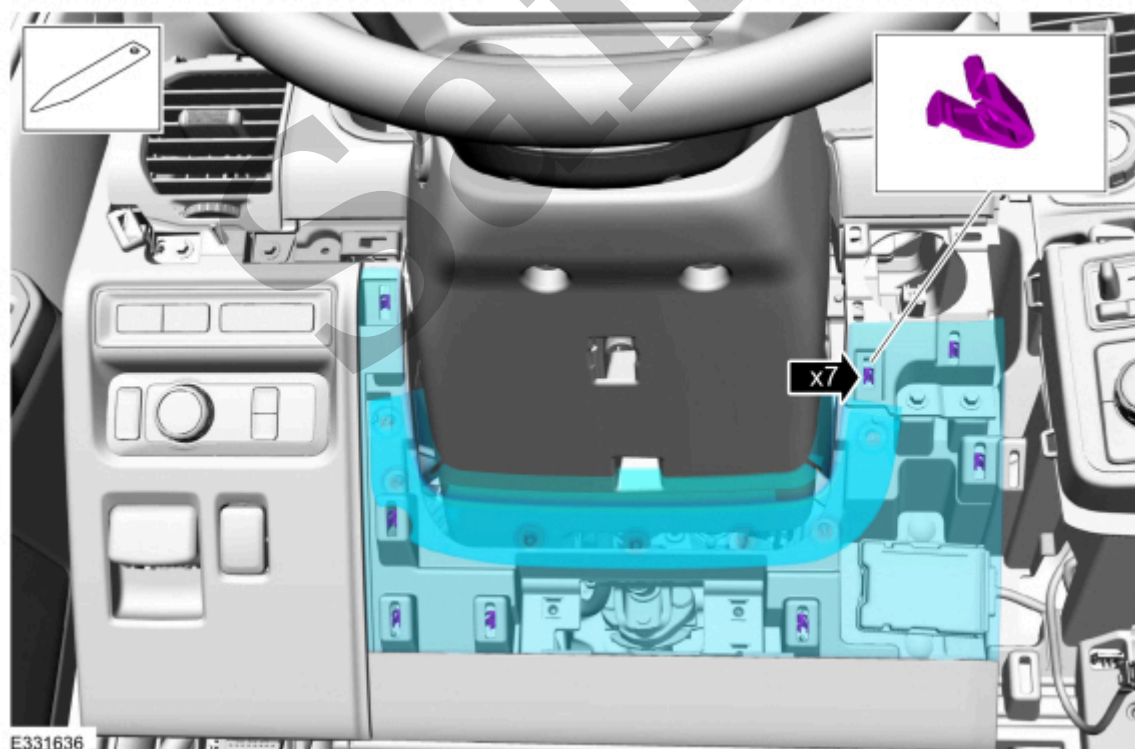

[Click here to learn about symbols, color coding, and icons used in this manual.](#)

[Click here to learn about symbols, color coding, and icons used in this manual.](#)

7. Remove the screws.

Torque : 22 lb.in (2.5 Nm)

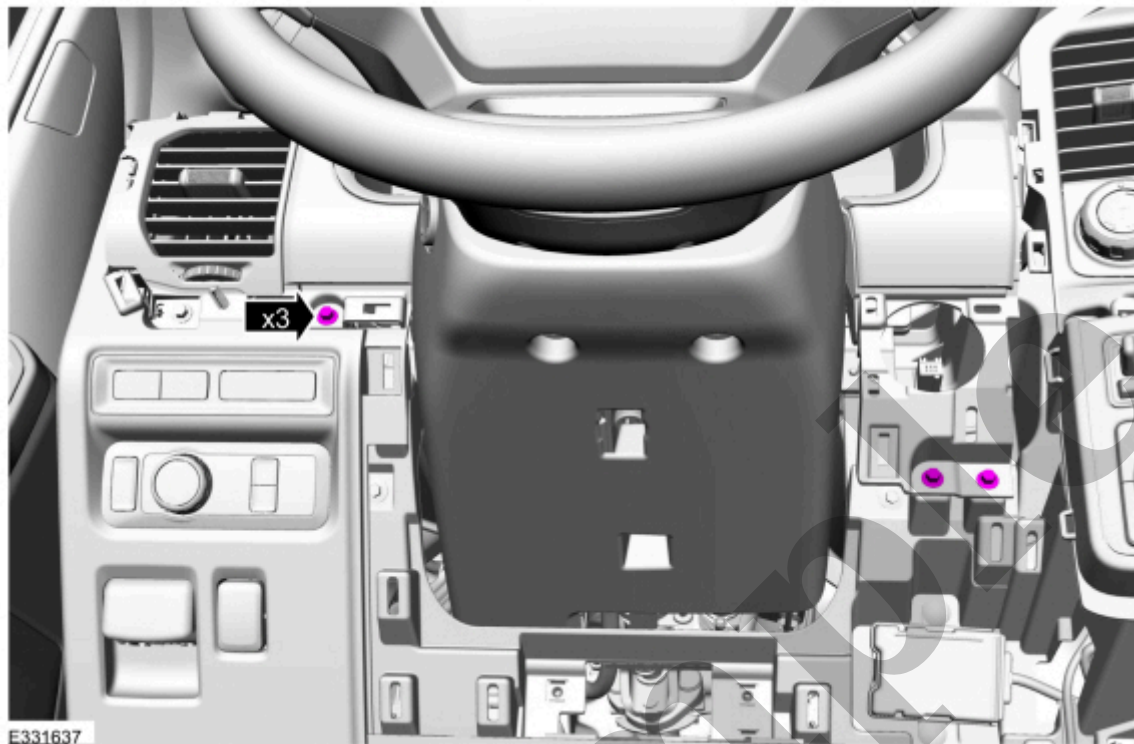

[Click here to learn about symbols, color coding, and icons used in this manual.](#)

8. Release the clips and remove the instrument cluster panel bezel.

10. Release the tabs and remove the register.

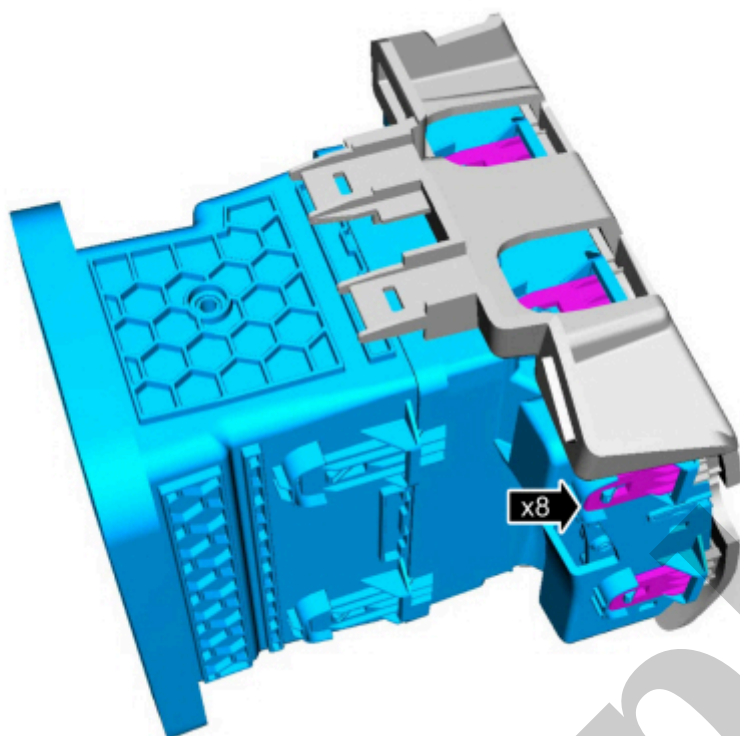

E332011

[Click here to learn about symbols, color coding, and icons used in this manual.](#)

Installation

1. To install, reverse the removal procedure.

Copyright © Ford Motor Company

- Disconnect the electrical connector.

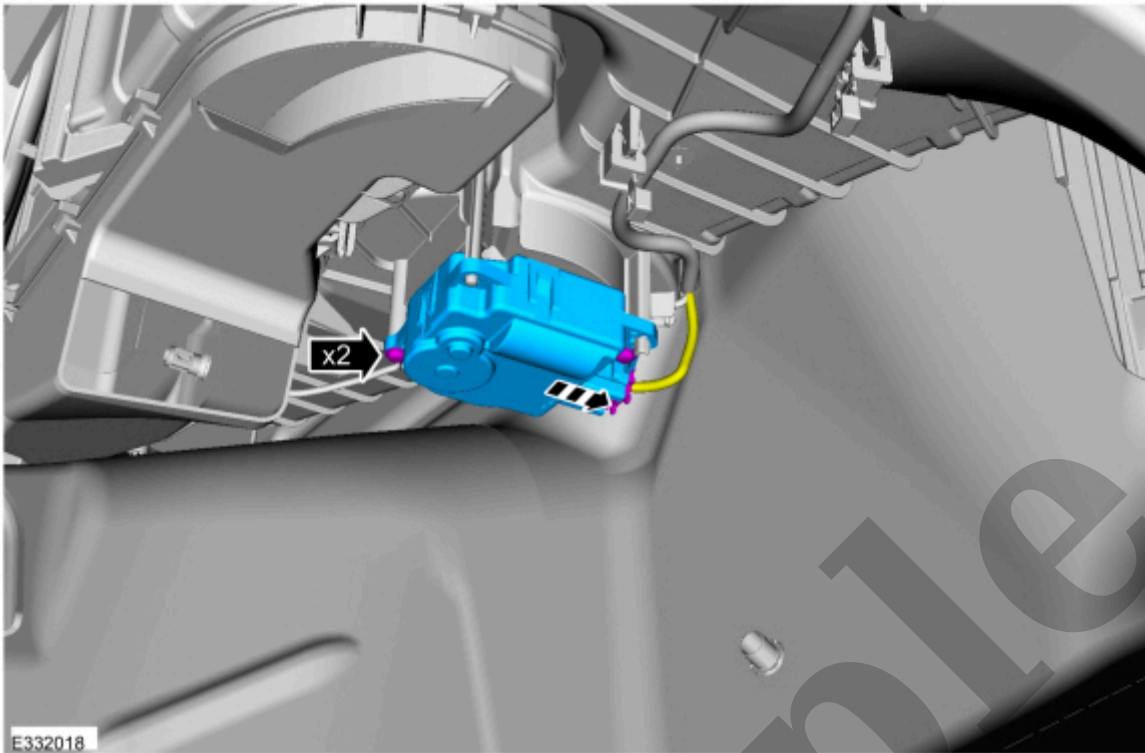

[Click here to learn about symbols, color coding, and icons used in this manual.](#)

3. **NOTE**

This step is only necessary when installing a new component.

Remove the cam from the driver side temperature door actuator, note the position of the cam.

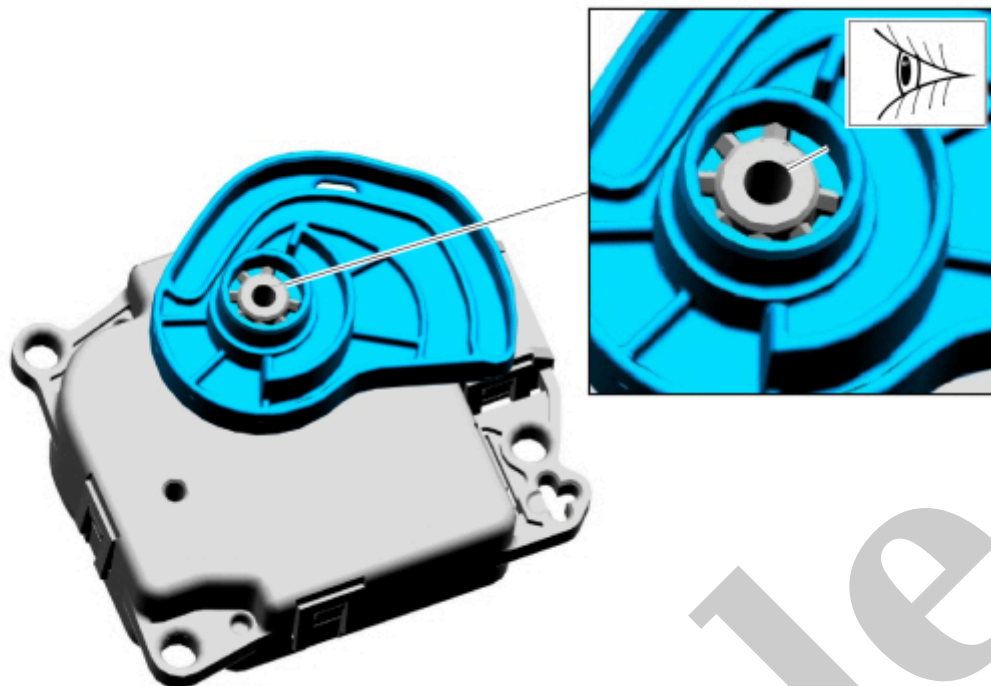

E276601

[Click here to learn about symbols, color coding, and icons used in this manual.](#)

2.
 1. Align the driver side temperature door actuator and cam to the temperature door.
 2. Install the driver side temperature door actuator and cam on the climate control housing with the retainers.
 3. Connect the electrical connector to the driver side temperature door actuator.



Evaporator Shutoff Valve - Electric

412-00 Climate Control System - General Information	2022 F-150
Removal and Installation	Procedure revision date: 04/13/2022

Evaporator Shutoff Valve - Electric

Removal

NOTE

Removal steps in this procedure may contain installation details.

1. NOTE

The evaporator shutoff valve is serviced with the A/C (air conditioning) line bundle line as an assembly.

Remove the A/C (air conditioning) line bundle.

Refer to: [Air Conditioning \(A/C\) Line Bundle - Electric](#)(412-00 Climate Control System - General Information, Removal and Installation).

Installation

1. To install, reverse the removal procedure.



Evaporator

412-00 Climate Control System - General Information	2022 F-150
Removal and Installation	Procedure revision date: 10/2/2020

Evaporator

Removal

NOTE

Removal steps in this procedure may contain installation details.

1. Remove the climate control housing.

Refer to: [Climate Control Housing](#)(412-00 Climate Control System - General Information, Removal and Installation).
2. Remove the seal.

4. **NOTE**

If equipped.

Remove the screws and the duct.

- Disconnect the electrical connectors and position aside the harness from the lower portion of the climate control housing.

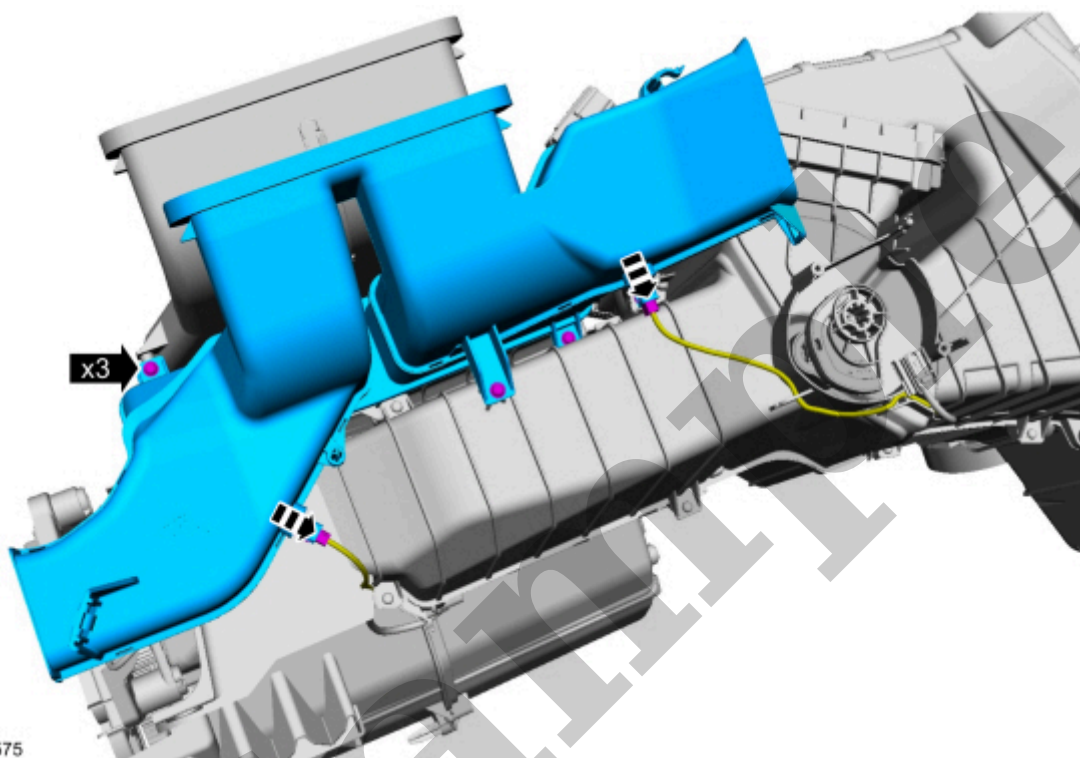

[Click here to learn about symbols, color coding, and icons used in this manual.](#)

5. Remove the actuator cam.



[Click here to learn about symbols, color coding, and icons used in this manual.](#)

7. Remove the screws and the lower portion of the climate control housing.

- Remove the harness retainer and position aside the harness.

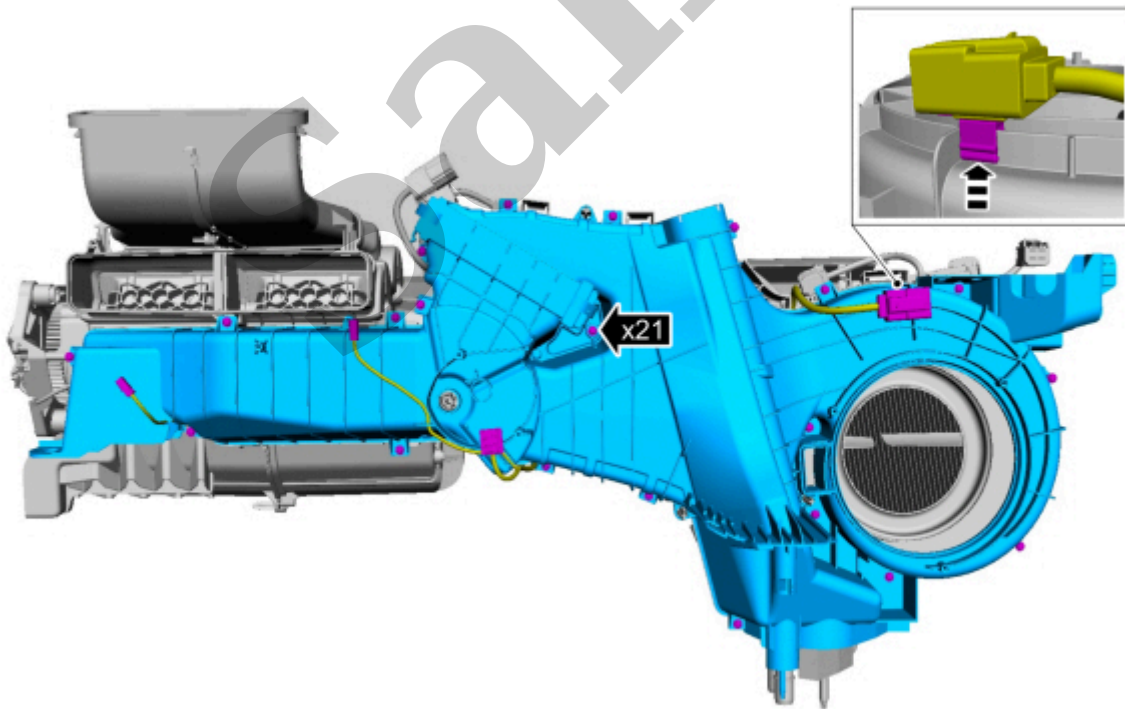

E328580

[Click here to learn about symbols, color coding, and icons used in this manual.](#)