

Your Ultimate Source for OEM Repair Manuals

FactoryManuals.net is a great resource for anyone who wants to save money on repairs by doing their own work. The manuals provide detailed instructions and diagrams that make it easy to understand how to fix a vehicle.

1992 FORD Escort 5 Doors OEM Service and Repair Workshop Manual

[Go to manual page](#)

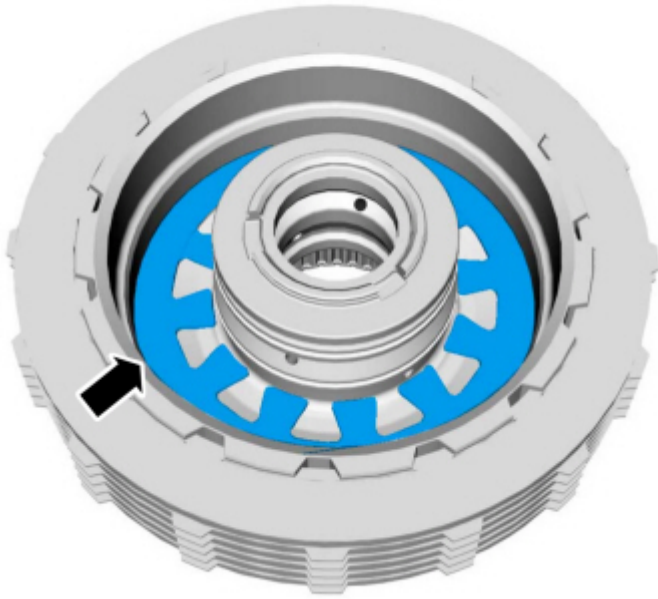

E243989

[Click here to learn about symbols, color coding, and icons used in this manual.](#)

186. Install a new E clutch balance dam outer seal. Lubricate the seal with petroleum jelly.

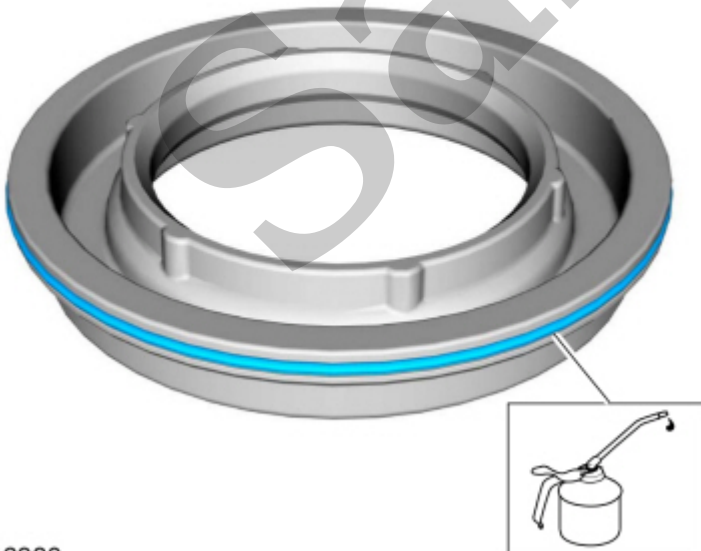

E246380

[Click here to learn about symbols, color coding, and icons used in this manual.](#)

187. Install the E clutch balance dam in the new E clutch piston.

[Click here to learn about symbols, color coding, and icons used in this manual.](#)

189. Install the new E clutch piston and balance dam in the E clutch hub.

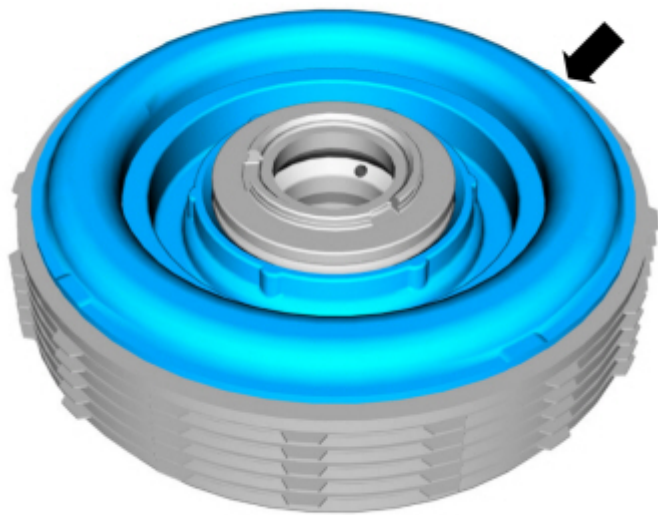

E244032

[Click here to learn about symbols, color coding, and icons used in this manual.](#)

190. **NOTICE**

Do not compress the balance dam too far or damage to the E clutch hub can occur. Only compress the E clutch hub far enough to install the retainer.

Using the special tool and a press, compress the E clutch balance dam and install the retainer.

Use Special Service Tool : 307-741 Spring Compressor, F Clutch

Use the General Equipment: Hydraulic Press

compare the measurement to the clutch clearance chart in specifications to determine the correct size pressure plate. Install the correct E clutch pressure plate.

Refer to: [Specifications](#)(307-01A Automatic Transmission - 10-Speed Automatic Transmission – 10R80, Specifications).

Use Special Service Tool : 100-002 (TOOL-4201-C) Holding Fixture with Dial Indicator Gauge

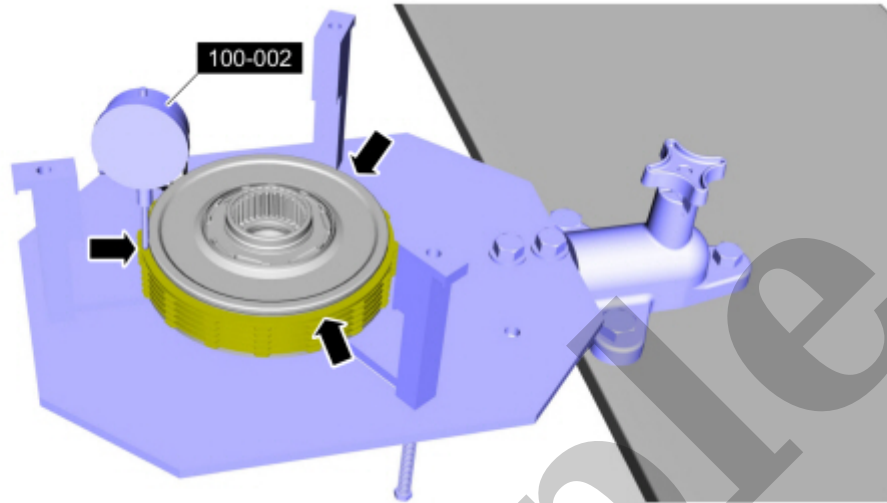

E244035

[Click here to learn about symbols, color coding, and icons used in this manual.](#)

193. **NOTE**

The E clutch seals have been updated to O-ring seals. The new seal kit may contain D-ring seals or O-ring seals, either can be used.

Install the new input shaft E clutch seals.

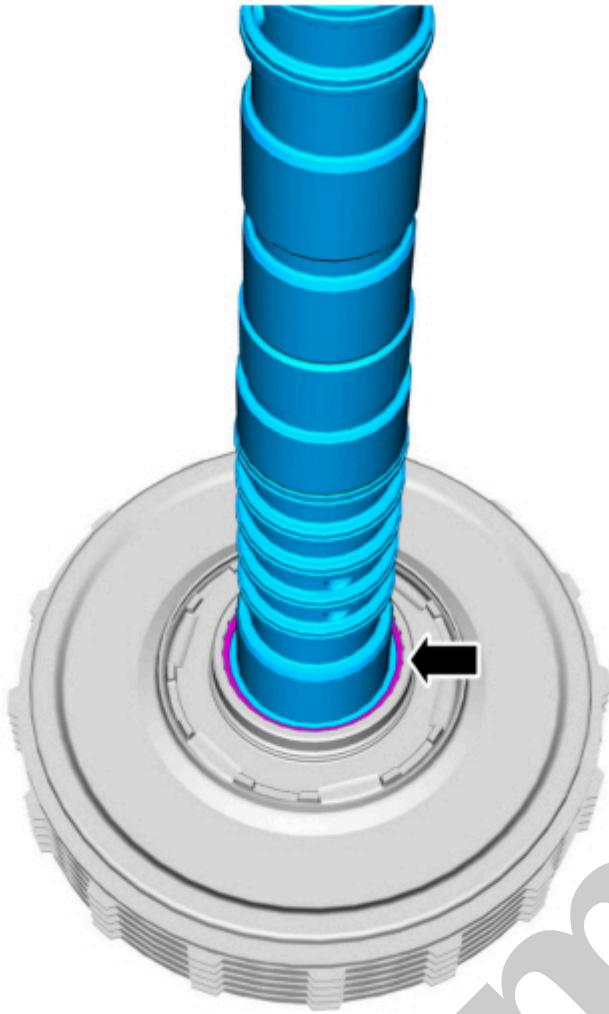

E243981

[Click here to learn about symbols, color coding, and icons used in this manual.](#)

195. Install the (T7) thrust bearing onto the E clutch with the tab locators up. Snap the bearing into place.

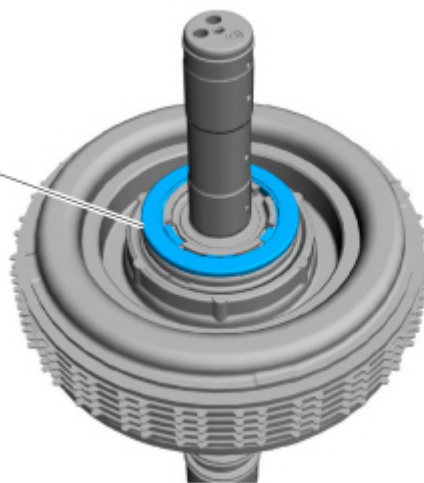
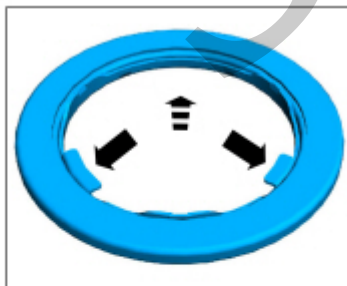

E298150

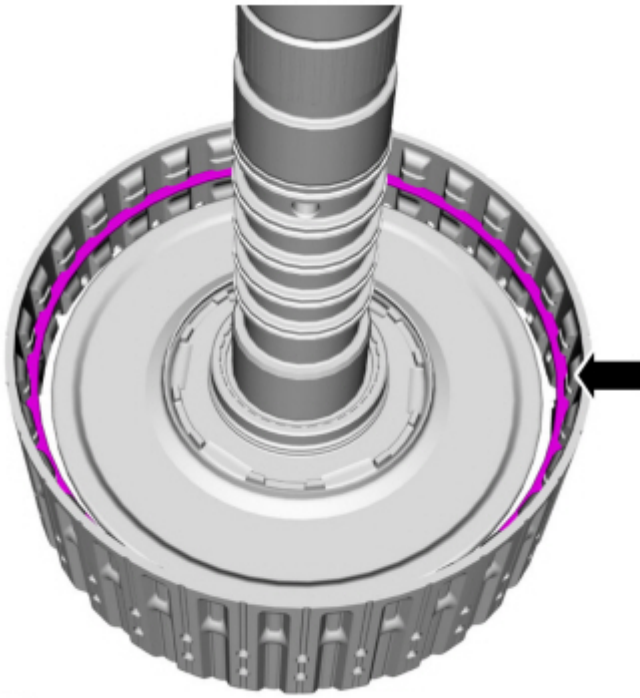

E243978

[Click here to learn about symbols, color coding, and icons used in this manual.](#)

198. Install the No. 3 ring gear and the snap ring. Align the snap ring gap 180° from the bottom snap ring gap.

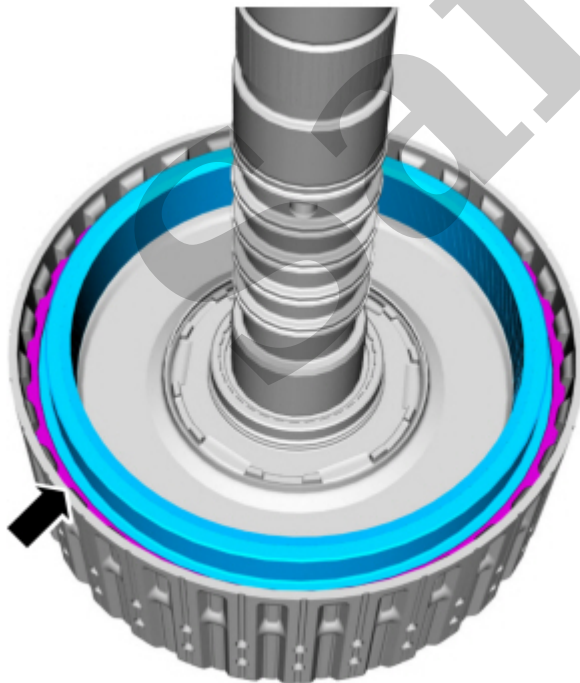

E243977

[Click here to learn about symbols, color coding, and icons used in this manual.](#)

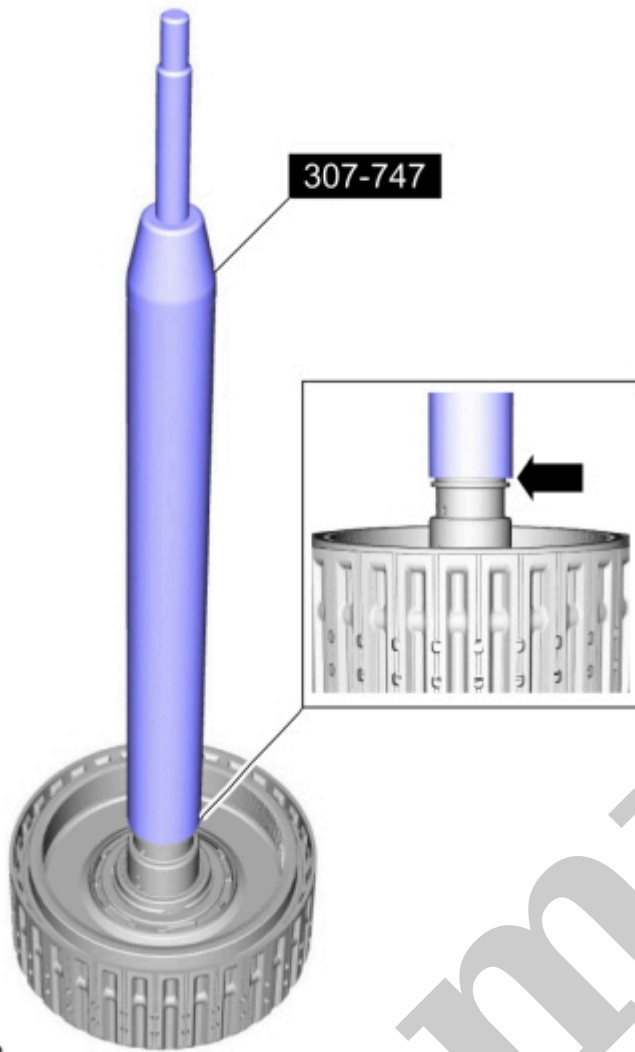

E245373

[Click here to learn about symbols, color coding, and icons used in this manual.](#)

201. Install a new Teflon® seal on the special tool.

Use Special Service Tool : 307-747 Installer/ Sizer , Input Shaft Solid Sealing Rings; Large

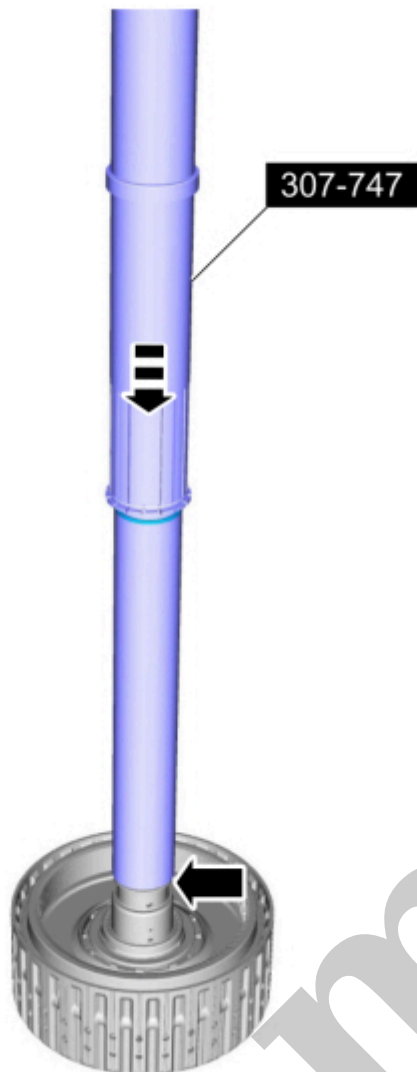

[Click here to learn about symbols, color coding, and icons used in this manual.](#)

203. Install the special tool to size the 5 Teflon® seals. Allow the special tool to stay on the input shaft until final assembly.

Use Special Service Tool : 307-747 Installer/ Sizer , Input Shaft Solid Sealing Rings; Large

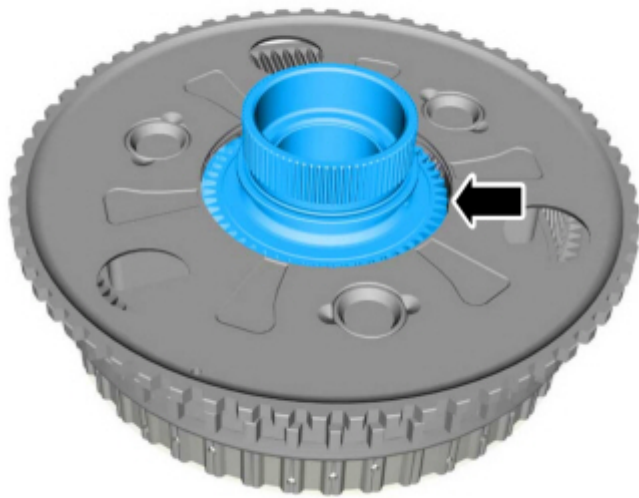

E242812

[Click here to learn about symbols, color coding, and icons used in this manual.](#)

205. Install the No. 2 sun gear.

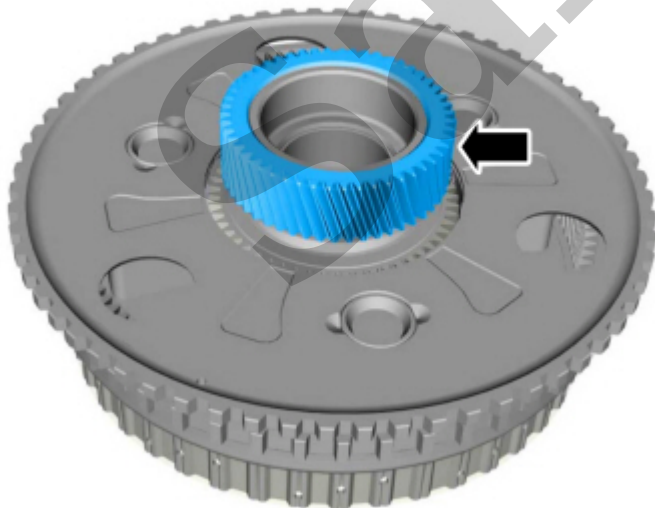

E242765

[Click here to learn about symbols, color coding, and icons used in this manual.](#)

206. Install the No. 2 planetary carrier.

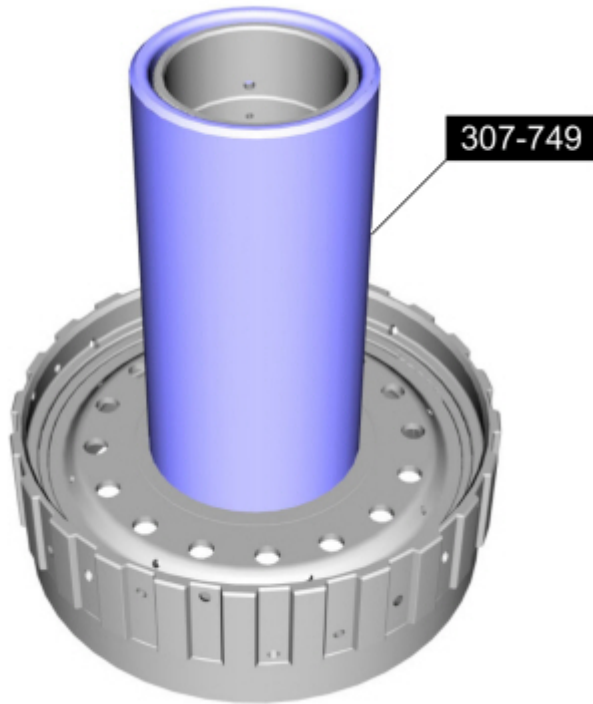

E245360

[Click here to learn about symbols, color coding, and icons used in this manual.](#)

209. Install the No. 3 sun gear shaft into the CDF clutch assembly.

1. Position the CDF clutch assembly on 2 blocks of wood.

Use the General Equipment: Wooden Block

2. Rotate the No. 3 sun gear shaft back and forth to install.

3. **NOTE**

When the No. 3 sun gear shaft is correctly installed the clearance between CDF clutch assembly and the special tool is approximately 1 mm.

Using the special tool and a feeler gauge, check the clearance between the CDF clutch assembly and the special tool.

Use Special Service Tool : 307-661 Gauge, End Play

Use the General Equipment: Feeler Gauge