

Your Ultimate Source for OEM Repair Manuals

FactoryManuals.net is a great resource for anyone who wants to save money on repairs by doing their own work. The manuals provide detailed instructions and diagrams that make it easy to understand how to fix a vehicle.

1988 JEEP Wagoneer OEM Service and Repair Workshop Manual

[Go to manual page](#)

Second Row Center - Short Wheelbase

SECOND ROW CENTER - SHORT WHEELBASE

REMOVAL

WARNING

To avoid serious or fatal injury during and following any seat belt or child restraint anchor service, carefully inspect all seat belts, buckles, mounting hardware, retractors, tether straps, and anchors for proper installation, operation, or damage. Replace any belt that is cut, frayed, or torn. Straighten any belt that is twisted. Tighten any loose fasteners. Replace any belt that has a damaged or ineffective buckle or retractor. Replace any belt that has a bent or damaged latch plate or anchor plate. Replace any child restraint anchor or the unit to which the anchor is integral that has been bent or damaged. Never attempt to repair a seat belt or child restraint component. Always replace damaged or ineffective seat belt and child restraint components with the correct, new and unused replacement parts listed in the Mopar® Parts Catalog. Failure to follow these instructions may result in possible serious or fatal injury.

1. Remove second row 60% seat back cover ([Refer to 23 - Body/Seats/COVER, Seat Back, Second Row 60%/Removal and Installation](#))([Refer To List 1](#)).
2. Remove the second row outboard left short wheelbase buckle ([Refer to Restraints/BUCKLE, Seat Belt/Removal and Installation](#)).

Second Row Outboard

SECOND ROW OUTBOARD

REMOVAL

WARNING

To avoid serious or fatal injury on vehicles equipped with airbags, disable the Supplemental Restraint System (SRS) before attempting any steering wheel, steering column, airbags, airbag curtains, knee blocker, seat belt tensioner, impact sensor or instrument panel component diagnosis or service. Disconnect the Intelligent Battery Sensor (IBS)/negative battery cable assembly from the negative battery post, then wait two minutes for the system capacitor to discharge before performing further diagnosis or service. This is the only sure way to disable the SRS. Failure to take the proper precautions could result in accidental airbag deployment.

WARNING

To avoid serious or fatal injury during and following any seat belt or child restraint anchor service, carefully inspect all seat belts, buckles, mounting hardware, retractors, tether straps, and anchors for proper installation, operation, or damage. Replace any belt that is cut, frayed, or torn. Straighten any belt that is twisted. Tighten any loose fasteners. Replace any belt that has a damaged or ineffective buckle or retractor. Replace any belt that has a bent or damaged latch plate or anchor plate. Replace any child restraint anchor or the unit to which the anchor is integral that has been bent or damaged. Never attempt to repair a seat belt or child restraint component. Always replace damaged or ineffective seat belt and child restraint components with the correct, new and unused replacement parts listed in the Mopar® Parts Catalog. Failure to follow these instructions may result in possible serious or fatal injury.

1. Position the appropriate upper C-pillar trim aside ([Refer to Body/Interior/PANEL, C-Pillar Trim, Upper/Removal and Installation](#)).
2. For short wheelbase, unbolt and position the rear seat forward to gain access to the anchor bolt ([Refer to Body/Seats, Second Row/SEAT, Second Row/Removal and Installation](#))([Refer To List 1](#)).

- Position the second row seat belt lower anchor to the vehicle. Be certain the seat belt webbing between the turning loop and the lower anchor is not twisted.

TORQUE SPECIFICATIONS - RESTRAINTS

DESCRIPTION	SPECIFICATION	COMMENT
Front Seat Belt Height Adjuster Bolts	55 N·m (41 Ft. Lbs.)	–
Front Seat Belt Buckle Bolt	54 N·m (40 Ft. Lbs.)	–
Front Seat Belt Tensioner Bolt	55 N·m (41 Ft. Lbs.)	–
Front Seat Belt Tensioner Bracket Bolts	48 N·m (35 Ft. Lbs.)	–
Front Seat Belt Retractor Bolt	55 N·m (41 Ft. Lbs.)	–
Front Seat Belt Turning Loop Nut	47 N·m (35 Ft. Lbs.)	–
Second Row Bucket Seat Belt Buckle Bolt	45 N·m (33 Ft. Lbs.)	–
Second Row Center Seat Belt Buckle Bolt	45 N·m (33 Ft. Lbs.)	–
Second Row Center Seat Belt Anchor Bolt	55 N·m (41 Ft. Lbs.)	–
Second Row Center Seat Belt Retractor Bolt	47 N·m (35 Ft. Lbs.)	–
Second Row Left Seat Belt Buckle Bolt	45 N·m (33 Ft. Lbs.)	–
Second Row Outboard Seat Belt Anchor Bolt	55 N·m (41 Ft. Lbs.)	–
Second Row Outboard Seat Belt Retractor Bolt	55 N·m (41 Ft. Lbs.)	–
Second Row Right Seat Belt Buckle Bolt	45 N·m (33 Ft. Lbs.)	–
Second Row Seat Belt Turning Loop Bolt - Long Wheelbase	48 N·m (35 Ft. Lbs.)	–
Second Row Seat Belt Turning Loop Bolt - Short Wheelbase	50 N·m (37 Ft. Lbs.)	–
Third Row Seat Belt Retractor Bolt	55 N·m (41 Ft. Lbs.)	–
Third Row Seat Belt Anchor Bolt .437-20X35.00	55 N·m (41 Ft. Lbs.)	–

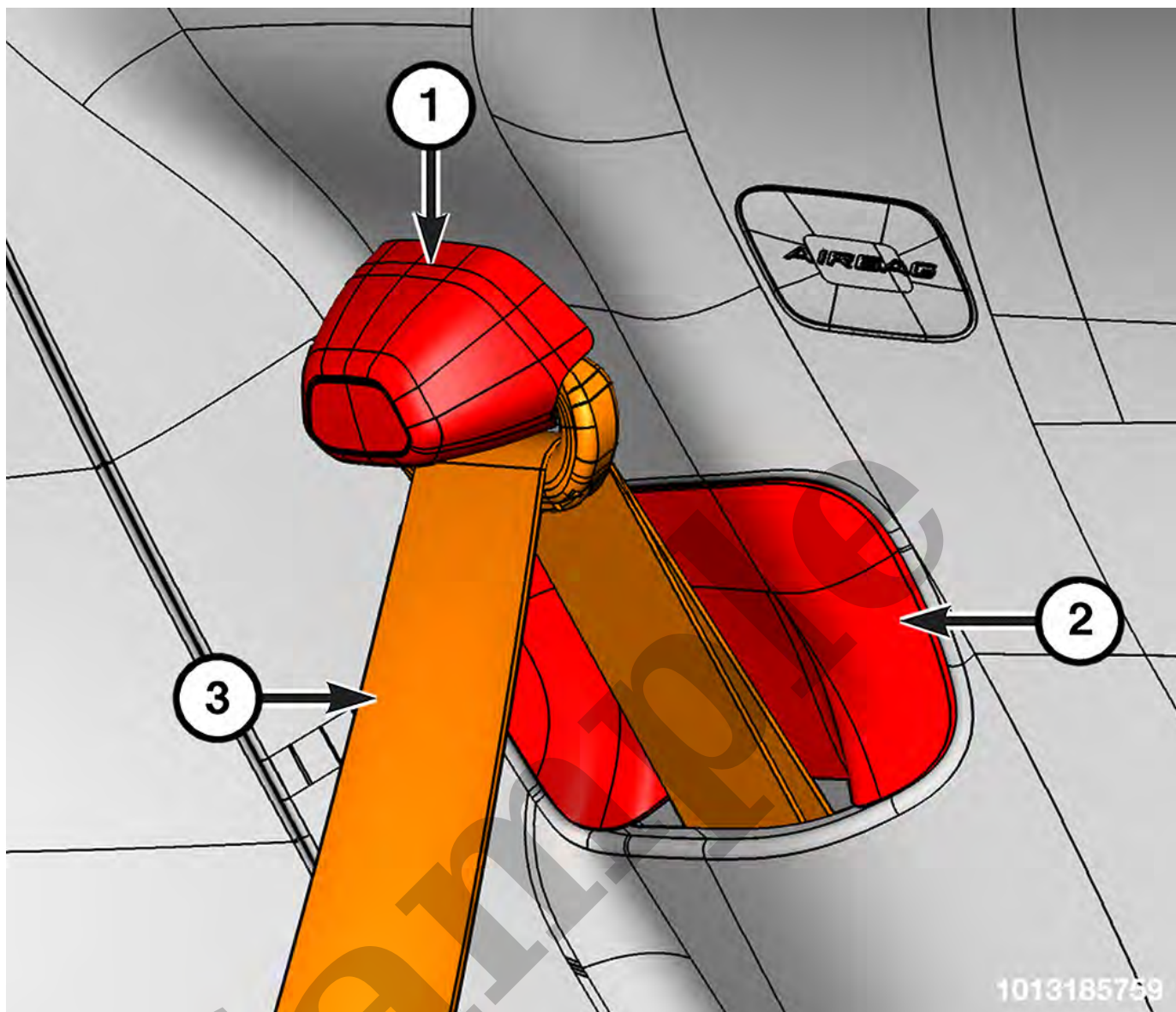

1 - Seat Belt Turning Loop Fastener Cover
2 - Seat Belt Closeout
3 - Seat Belt

3. Using a trim stick or equivalent, release the seat belt closeout and the seat belt turning loop fastener cover.

DESCRIPTION	SPECIFICATION	COMMENT
Third Row Seat Belt Anchor Bolt .437-20X40.00	48 N·m (35 Ft. Lbs.)	–
Third Row Seat Belt Buckle Assembly Bolt	45 N·m (33 Ft. Lbs.)	–
Third Row Seat Belt Turning Loop Bolt	48 N·m (35 Ft. Lbs.)	–

Sample

C-Pillar Impact Sensor

C-PILLAR IMPACT SENSOR

REMOVAL

WARNING

To avoid serious or fatal injury on vehicles equipped with airbags, disable the Supplemental Restraint System (SRS) before attempting any steering wheel, steering column, airbags, airbag curtains, knee blocker, seat belt tensioner, impact sensor or instrument panel component diagnosis or service. Disconnect the Intelligent Battery Sensor (IBS)/negative battery cable assembly from the negative battery post, then wait two minutes for the system capacitor to discharge before performing further diagnosis or service. This is the only sure way to disable the SRS. Failure to take the proper precautions could result in accidental airbag deployment.

WARNING

To avoid serious or fatal injury, never strike or drop the side impact sensor, as it can damage the impact sensor or affect its calibration. The side impact sensor enables the system to deploy the side Supplemental Restraint System (SRS) components. If an impact sensor is accidentally dropped during service, the sensor must be scrapped and replaced with a new unit. Failure to observe this warning could result in accidental, incomplete, or improper side SRS component deployment.

1. Disconnect and isolate the negative battery cable(s) ([Refer to Electrical/Battery System/Standard Procedure](#)). Wait 2 minutes for the system capacitor to discharge before continuing service.
2. Remove the quarter panel trim ([Refer to Body/Interior/PANEL, Quarter Trim, Rear/Removal and Installation](#)).

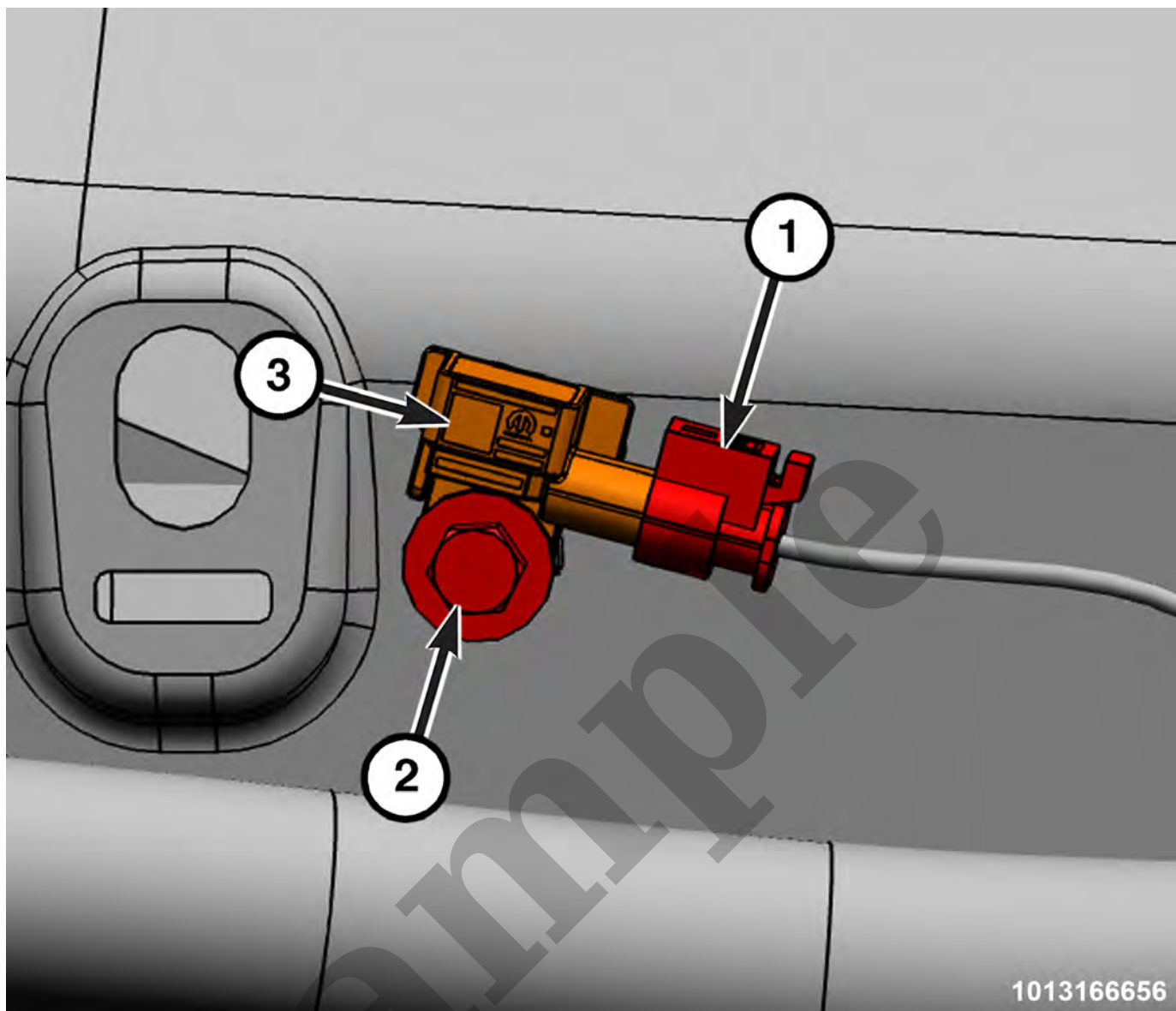

1 - Wire Harness Connector
2 - D-Pillar Impact Sensor Screw
3 - D-Pillar Impact Sensor

3. Disconnect the body wire harness connector from the D-pillar impact.

4. Remove the screw that secures the sensor to the inner D-pillar.

5. Disengage the locating and anti-rotation pin of the sensor from the clearance hole in the inner D-pillar.

6. Remove the D-pillar impact sensor from the vehicle.

INSTALLATION

- Do not connect the negative battery cable at this time. The Supplemental Restraint System (SRS) Verification Test procedure should be performed following service of any SRS component ([Refer to Restraints - Standard Procedure](#)).

TORQUE SPECIFICATIONS - IMPACT SENSORS

DESCRIPTION	SPECIFICATION	COMMENT
B-Pillar Impact Sensor Screw M6x1.00x25.00	8 N·m (71 In. Lbs.)	–
B-Pillar Impact Sensor Screw M6x1.00x30.00	11 N·m (8 Ft. Lbs.)	–
C-Pillar Impact Sensor Screw M6x1.00x25.00	8 N·m (71 In. Lbs.)	–
C-Pillar Impact Sensor Screw M6x1.00x30.00	11 N·m (8 Ft. Lbs.)	–
D-Pillar Impact Sensor Screw	8 N·m (71 In. Lbs.)	–
Front Door Impact Sensor Screws	9 N·m (80 In. Lbs.)	–
Front Impact Sensor Nut	9 N·m (80 In. Lbs.)	–

Seat Track Position Sensor

SEAT TRACK POSITION SENSOR

REMOVAL

WARNING

To avoid serious or fatal injury on vehicles equipped with airbags, disable the Supplemental Restraint System (SRS) before attempting any steering wheel, steering column, airbags, airbag curtains, knee blocker, seat belt tensioner, impact sensor or instrument panel component diagnosis or service. Disconnect the Intelligent Battery Sensor (IBS)/negative battery cable assembly from the negative battery post, then wait two minutes for the system capacitor to discharge before performing further diagnosis or service. This is the only sure way to disable the SRS. Failure to take the proper precautions could result in accidental airbag deployment.

1. Disconnect and isolate the negative battery cable(s) ([Refer to Electrical/Battery System/Standard Procedure](#)). Wait 2 minutes for the system capacitor to discharge before continuing service.