

Your Ultimate Source for OEM Repair Manuals

FactoryManuals.net is a great resource for anyone who wants to save money on repairs by doing their own work. The manuals provide detailed instructions and diagrams that make it easy to understand how to fix a vehicle.

1986 CHEVROLET Camaro OEM Service and Repair Workshop Manual

[Go to manual page](#)

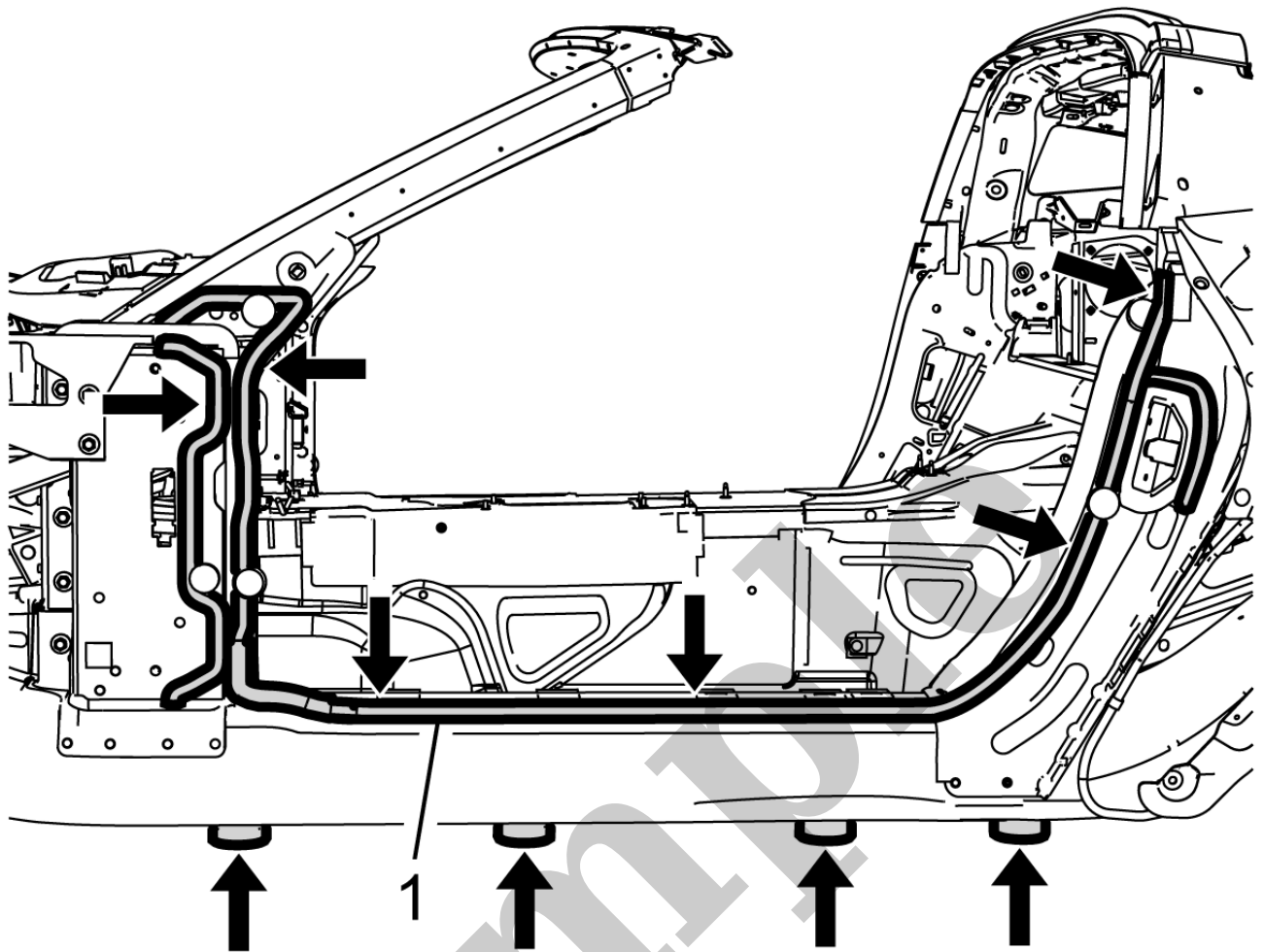

5. Remove the door frame by applying heat and pry to detach the adhesive (1) along the bonding surface.
6. Remove the door frame from the vehicle.
7. Note the location of the adhesive and remove only the loose adhesive.
8. Inspect the side structure and frame rails for damage.

Installation Procedure

1. Before applying adhesive dry fit the door frame for proper fit and alignment.

2. NOTE

Note

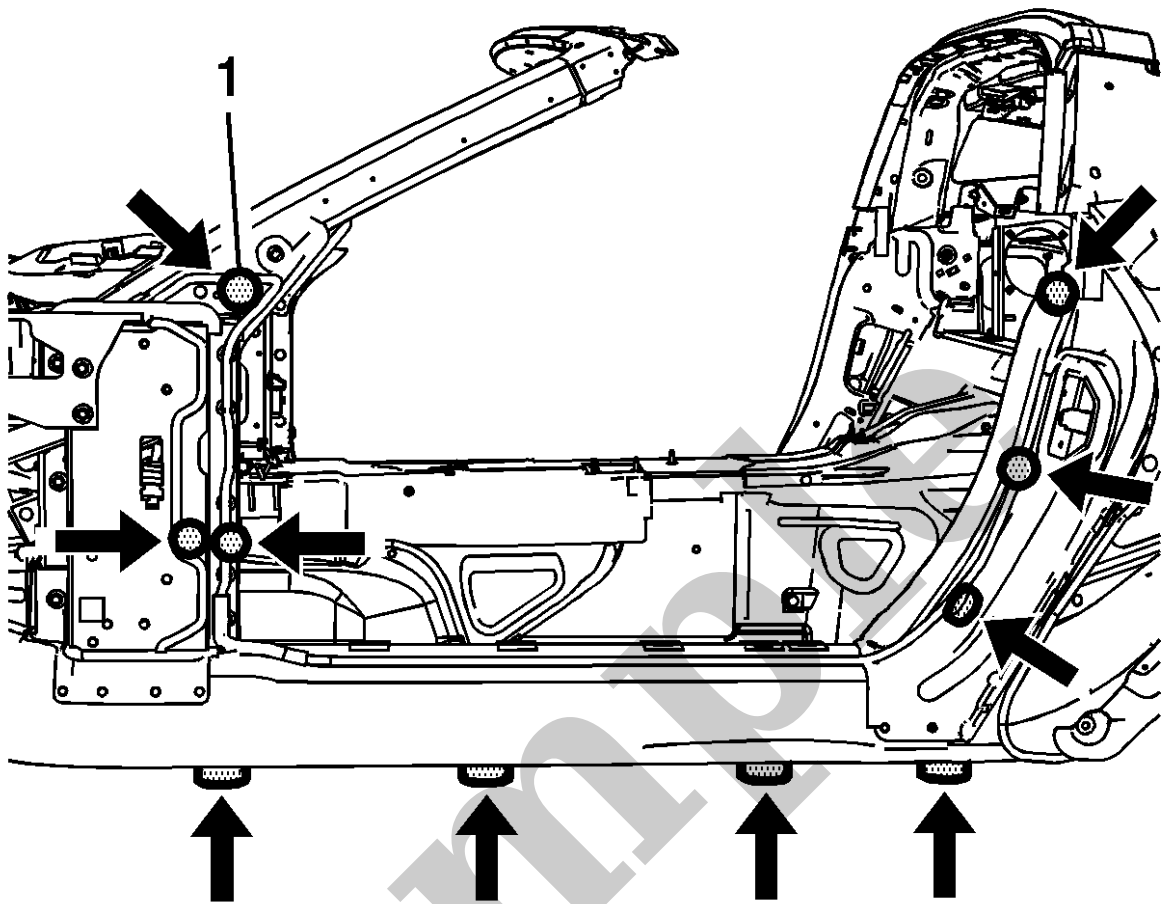

5.
Apply dollops of structural adhesive (1) to the original locations on the body side. Refer to [Sheet Molded Compound \(SMC\) Panel Bonding](#).
6. Install the door frame on the vehicle.
7. Apply pressure to the door frame to set the adhesive.
8. Clamp or tape the door frame in place as necessary.
9. Remove any excess adhesive.
10. Install all related panels and components.
11. Connect the negative battery cable. Refer to [Battery Negative Cable Disconnection and Connection](#).
12. Enable the SIR system. Refer to [SIR Disabling and Enabling](#).

NOTE

Note

Bench and fixturing of the body structure recommended.



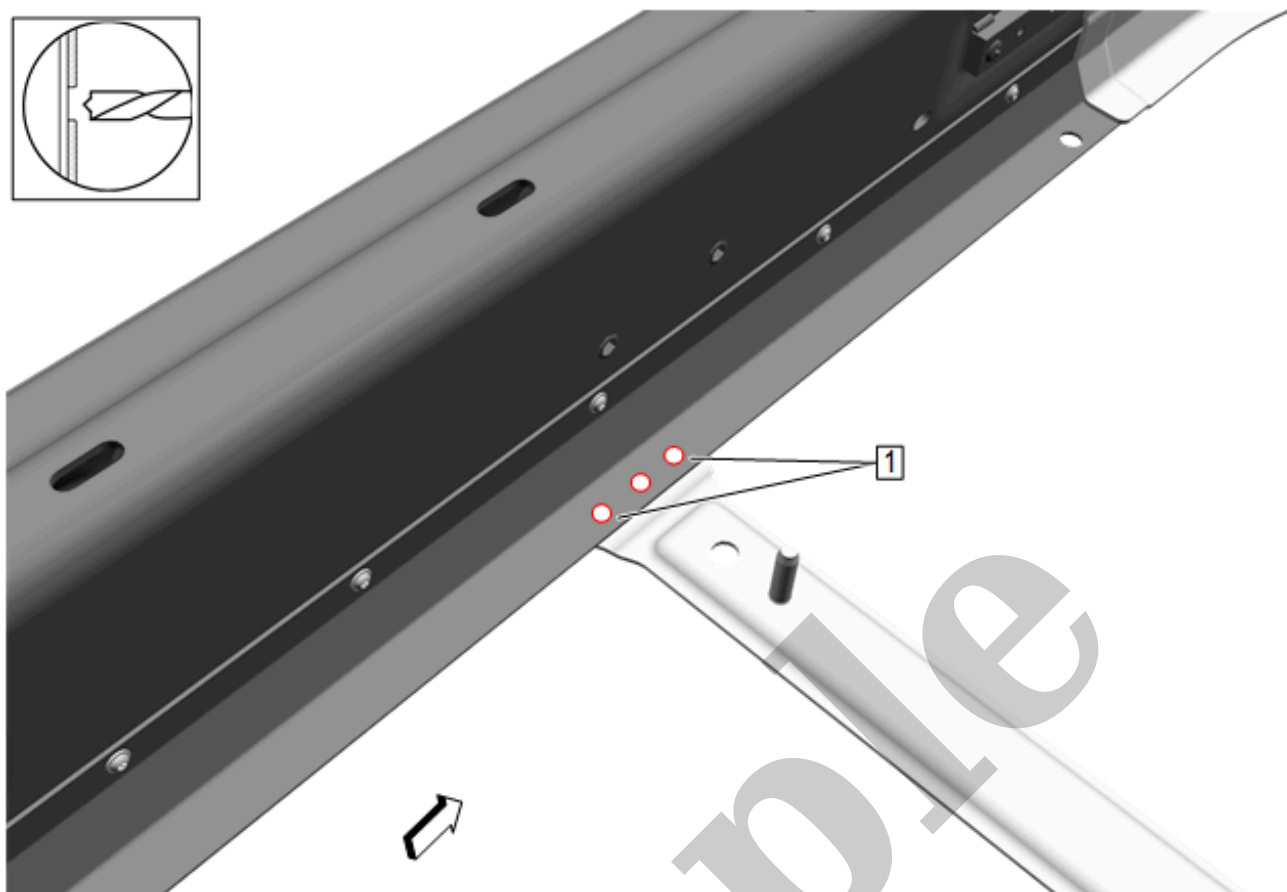
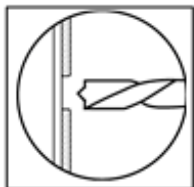

5.

WARNING

Warning

When separating the aluminum panels during collision repair, be sure to adhere to the following precautions:

- Do not use an open flame
- Focus heat onto panel being replaced and do not exceed 200°C (392°F) for 3 consecutive minutes
- Use care not to damage adjacent panel while prying the panels apart

Failure to follow the precautions may lead to vehicle damage or personal injury.

NOTE

Note

Drill through surface layer only.

Locate and remove spot welds (1) joining number 2 bar to side rail assembly [3X].