

Your Ultimate Source for OEM Repair Manuals

FactoryManuals.net is a great resource for anyone who wants to save money on repairs by doing their own work. The manuals provide detailed instructions and diagrams that make it easy to understand how to fix a vehicle.

1983 CHEVROLET Camaro OEM Service and Repair Workshop Manual

[Go to manual page](#)

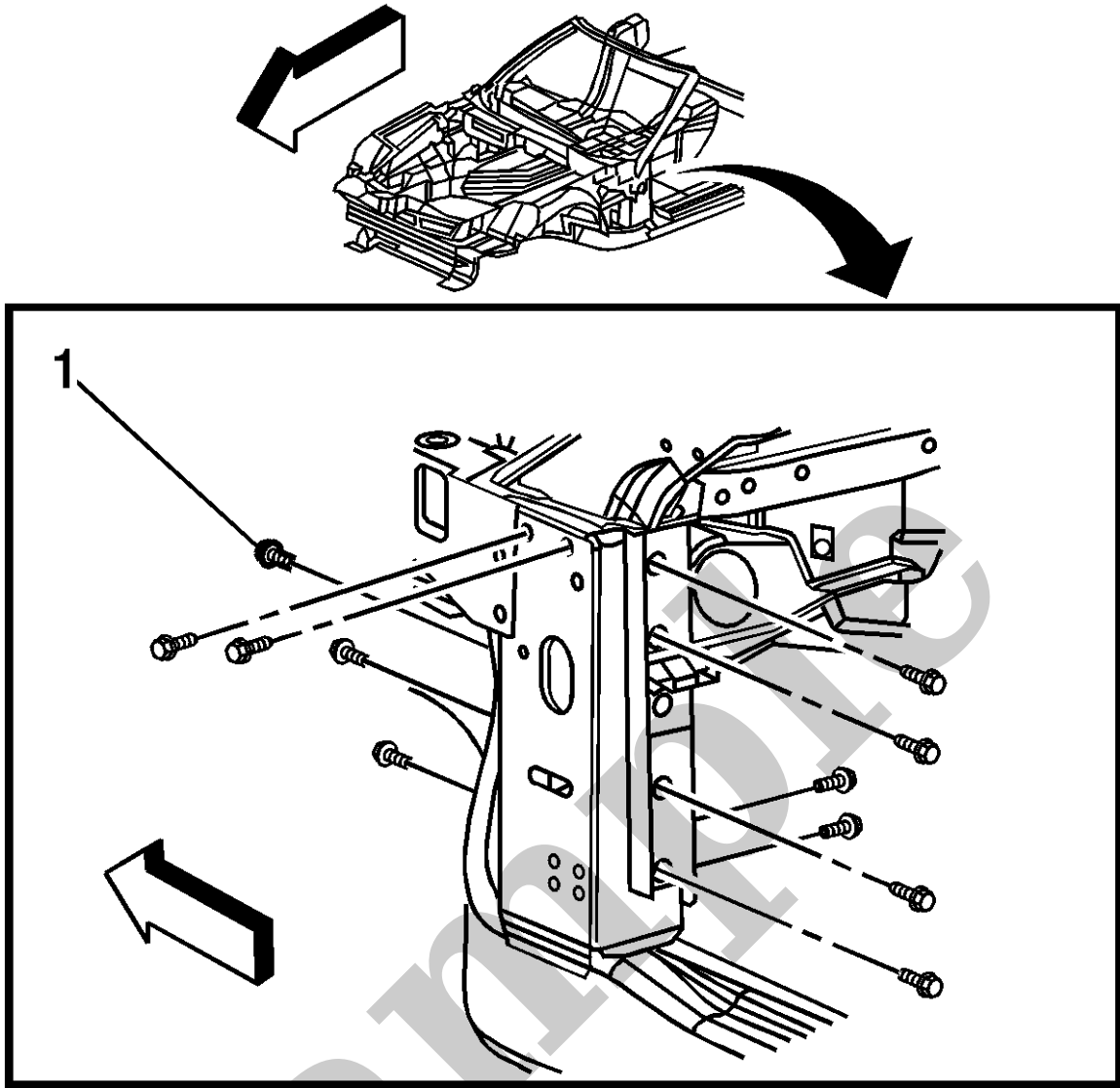

6.

Remove the bolts (1) attaching the front hinge pillar to the windshield frame.

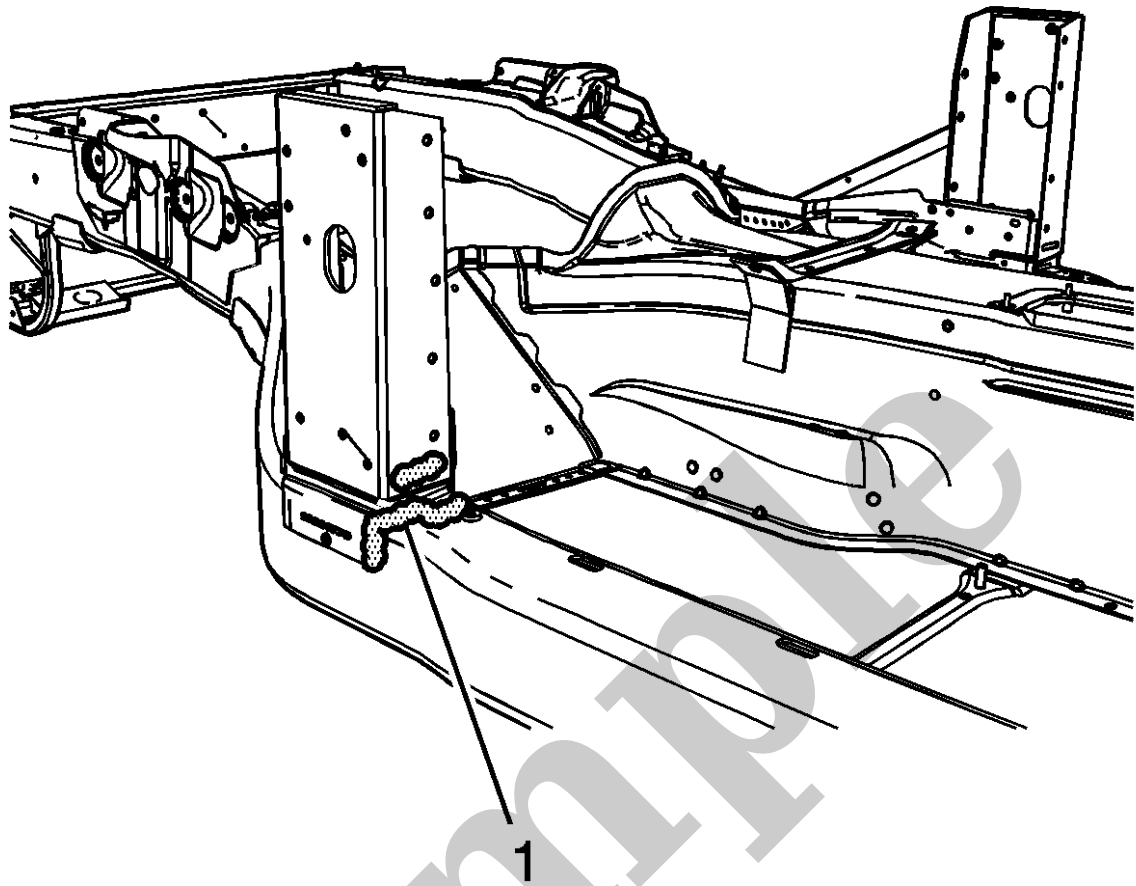

8.

Locate and remove all factory welds (1) from the rear outer hinge pillar. Note the number and location of the welds for installation of the new hinge pillar.

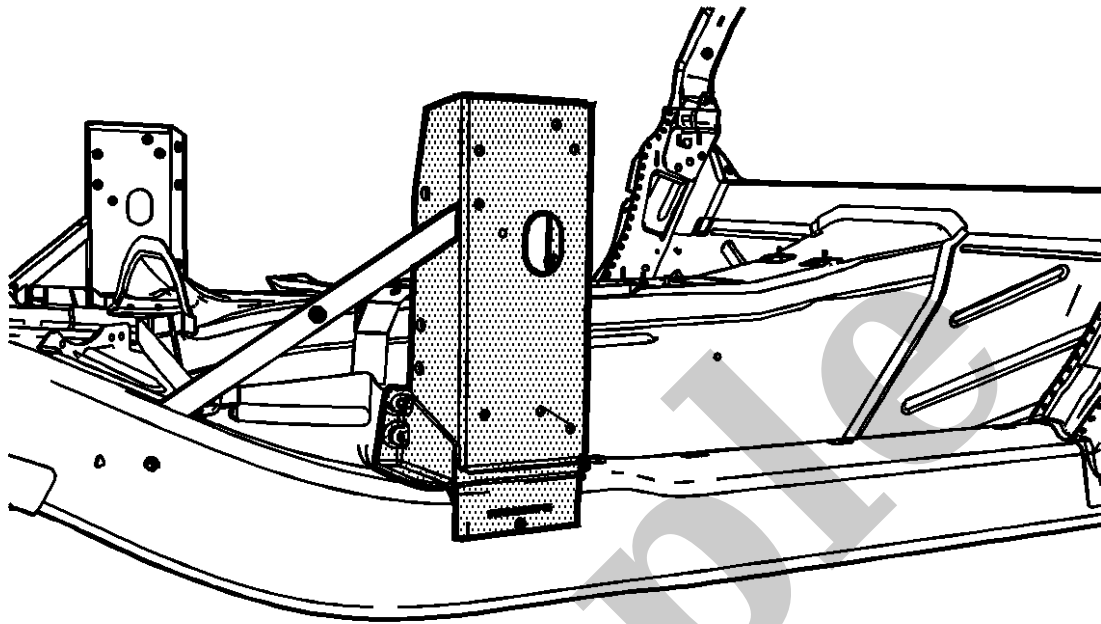

10.
Remove the damaged hinge pillar.
11. Note the location of the adhesive and remove all remaining loose adhesive.

Installation Procedure

1. Before applying the adhesive, dry fit the hinge pillar for proper fit and alignment.

2. **NOTE**

Note

Use primer only on bonding surfaces. Do NOT top coat any bonding surfaces. Refer to the adhesive manufacturer's recommendation.

6. **NOTE**

Note

Use a stainless steel brush to remove the oxide layer prior to welding.

Prepare all welding attachment surfaces as necessary.

NOTE

Note

Recommend wire alloy is 4043 and wire size is 0.035. The shielding gas is 100 percent Argon. A 2 minute cooling down period is recommend for every 2 minutes or 100 mm (4 in) of welding.

Using a PULSED-MIG welder, tack weld the hinge pillar to the vehicle.

Sample