

# Your Ultimate Source for OEM Repair Manuals

FactoryManuals.net is a great resource for anyone who wants to save money on repairs by doing their own work. The manuals provide detailed instructions and diagrams that make it easy to understand how to fix a vehicle.

## 1981 VOLVO 265 OEM Service and Repair Workshop Manual

[Go to manual page](#)

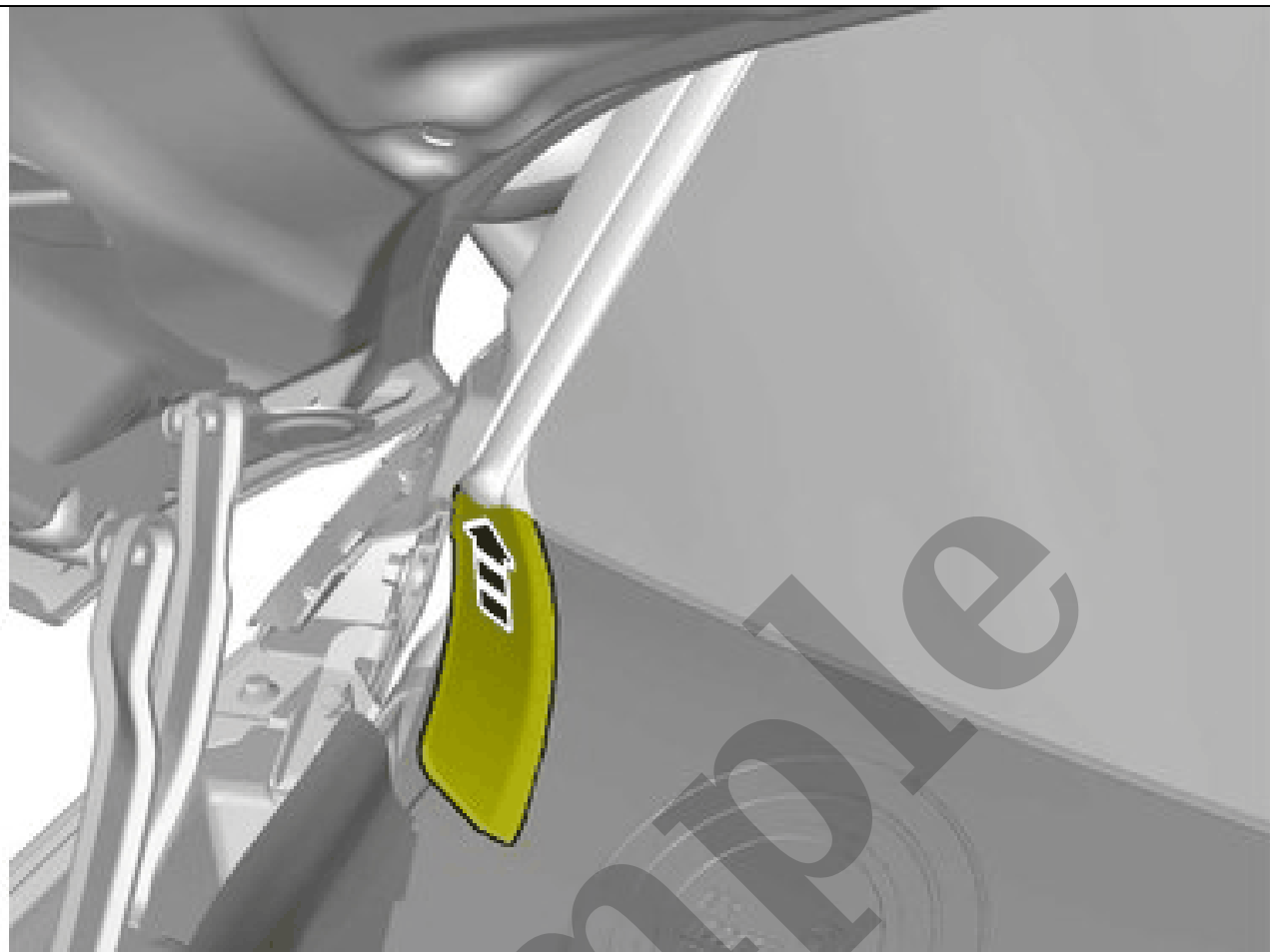

Courtesy of VOLVO CARS CORPORATION

Fold marked part aside.  
Repeat on the other side.



Courtesy of VOLVO CARS CORPORATION

Reinstall the removed parts in reverse order.

**SETTING**



Courtesy of VOLVO CARS CORPORATION

## Component overview

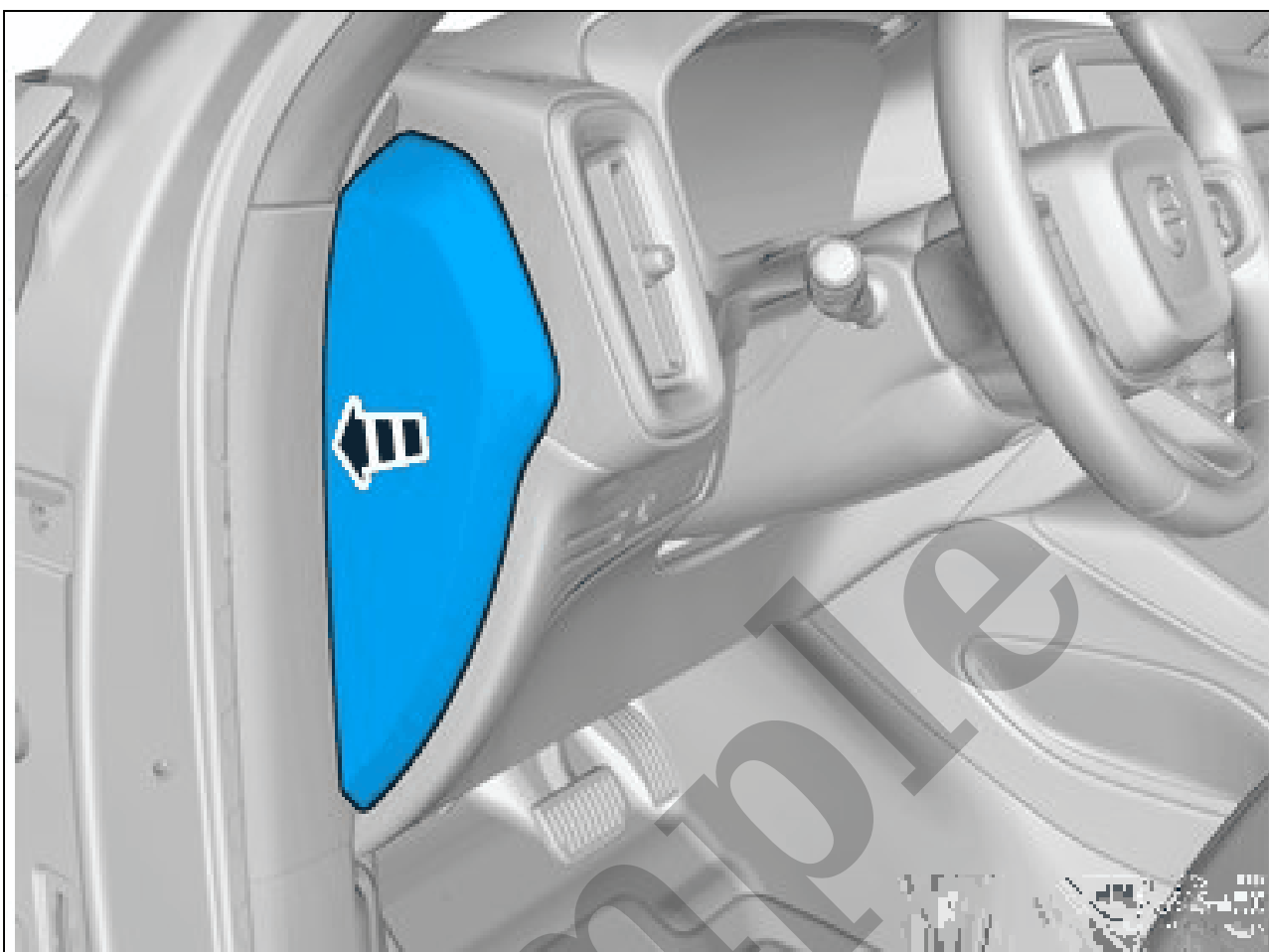

Courtesy of VOLVO CARS CORPORATION

Remove the marked part.

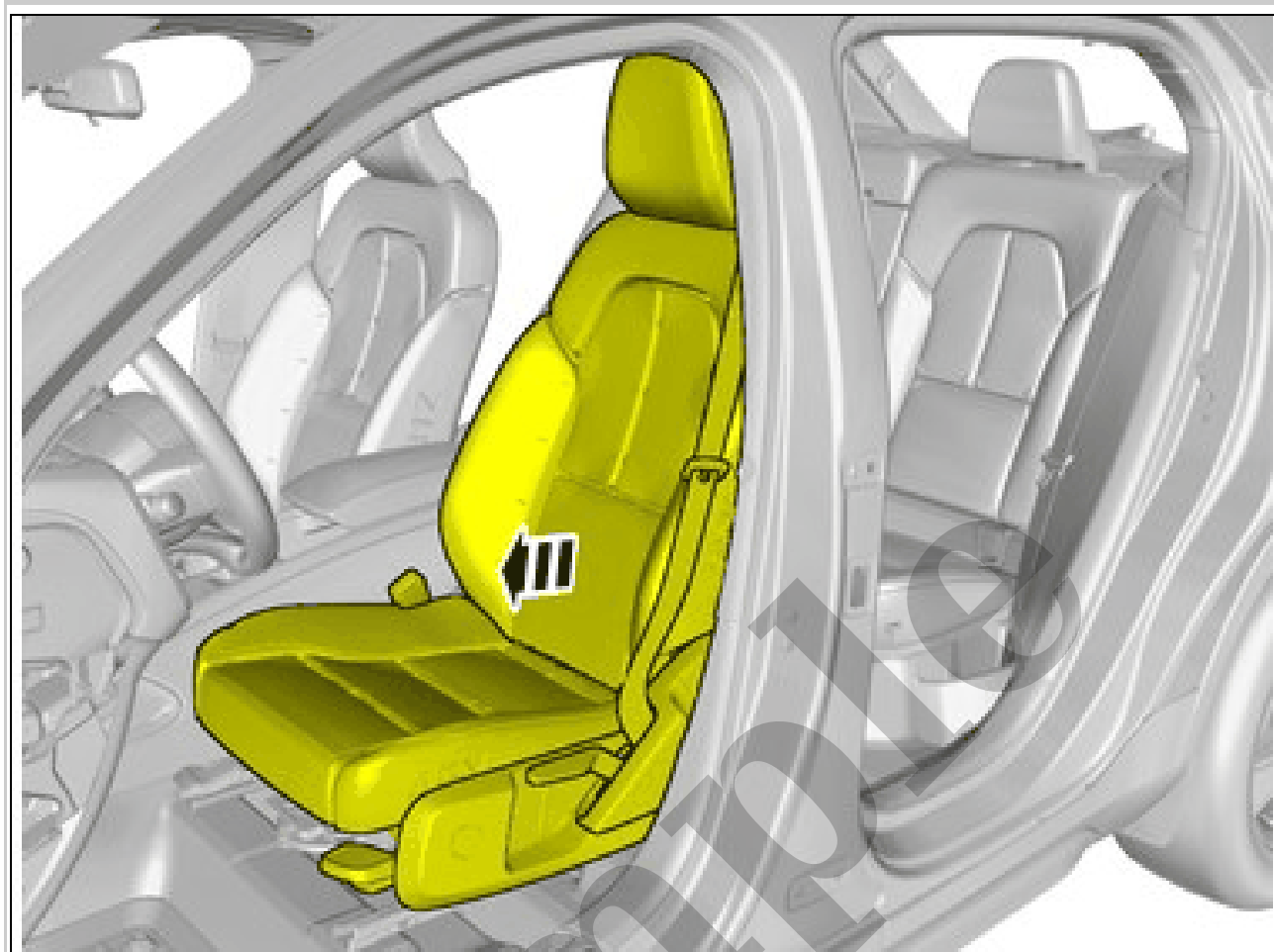

Courtesy of VOLVO CARS CORPORATION

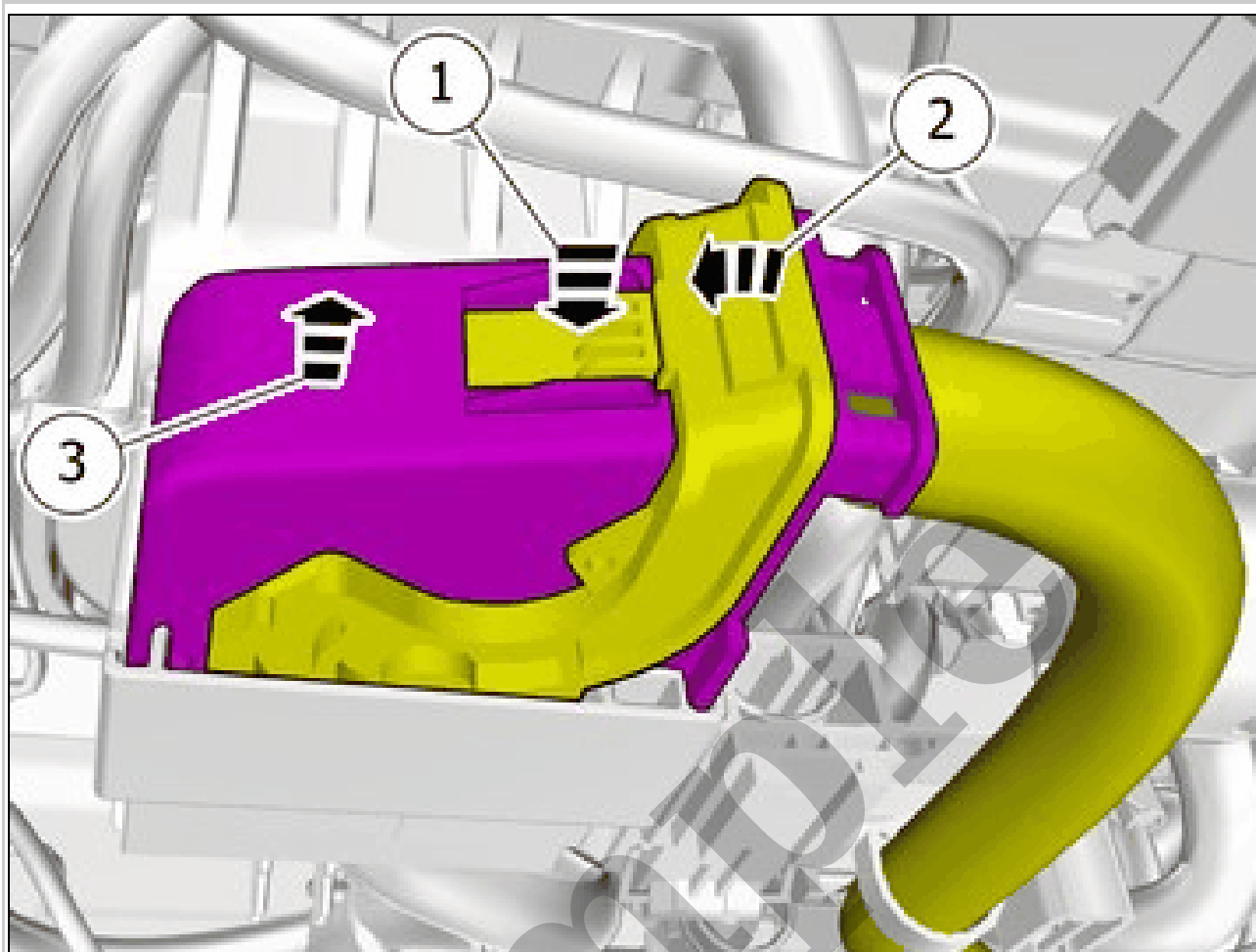

Courtesy of VOLVO CARS CORPORATION

Disconnect the connector.

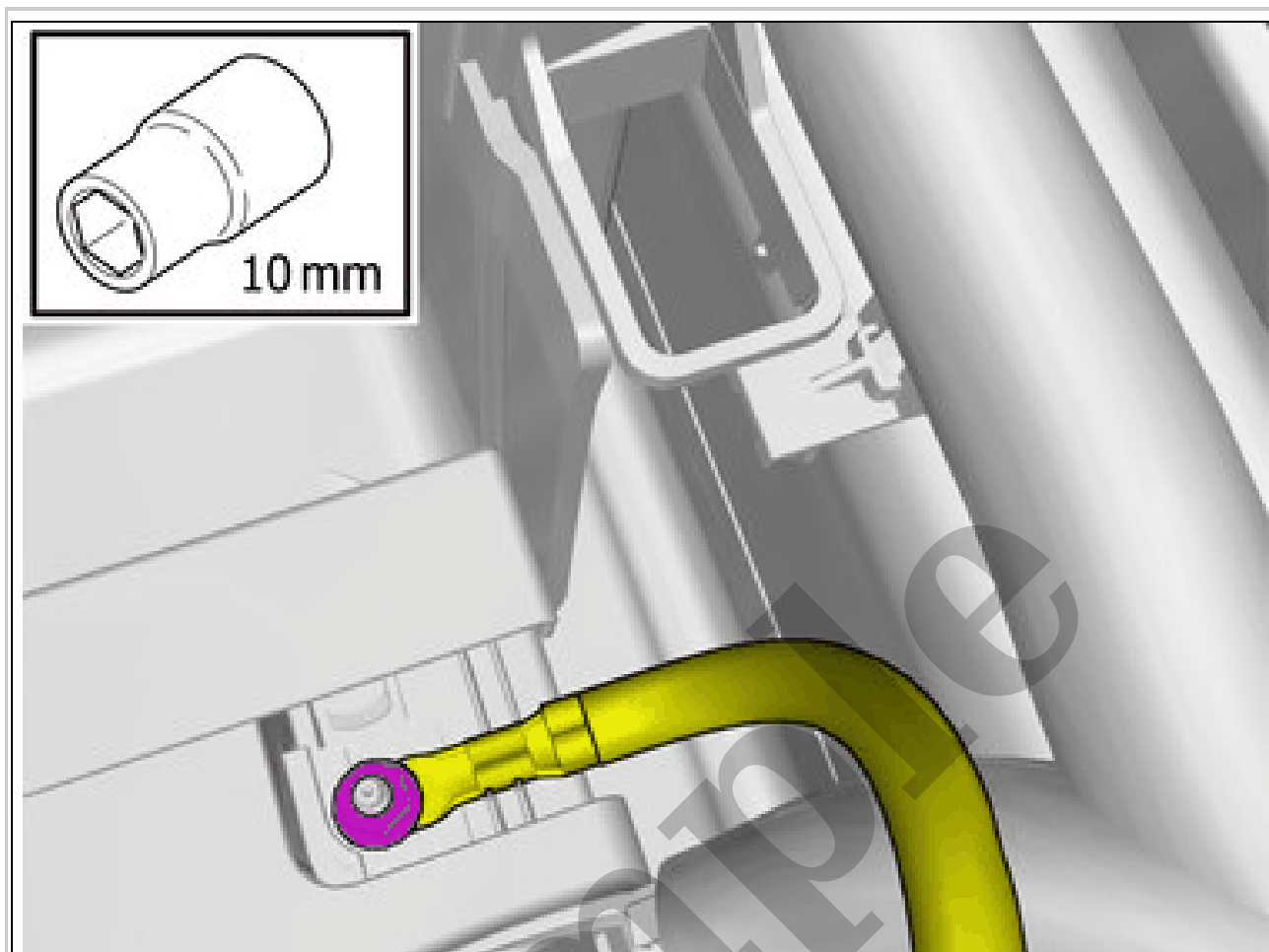

Courtesy of VOLVO CARS CORPORATION

Remove the nut.  
Fold marked part aside.  
**Torque:** M6, 10Nm



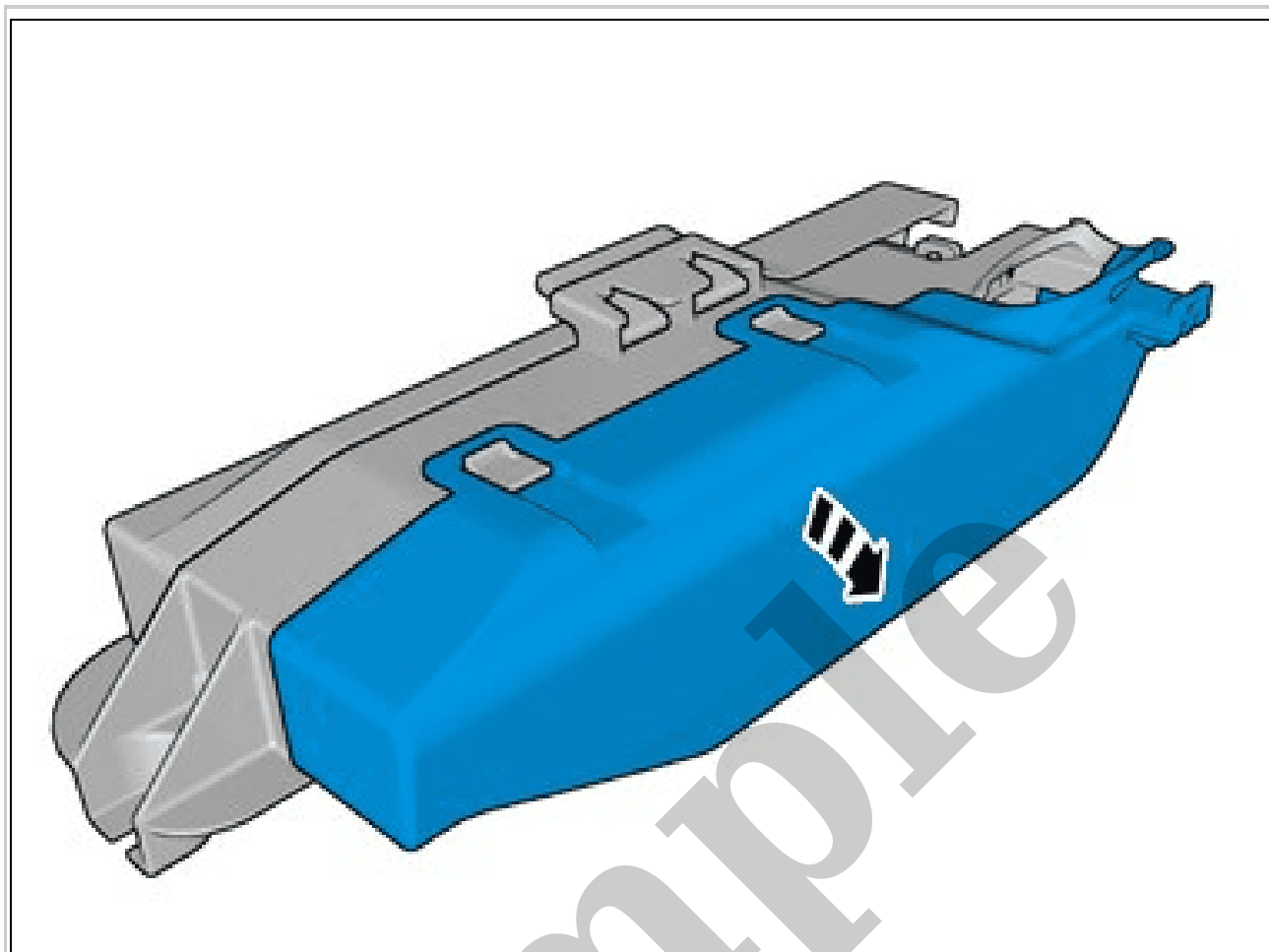

Courtesy of VOLVO CARS CORPORATION

Remove the marked part.

**ACCESSORY INSTALLATION**

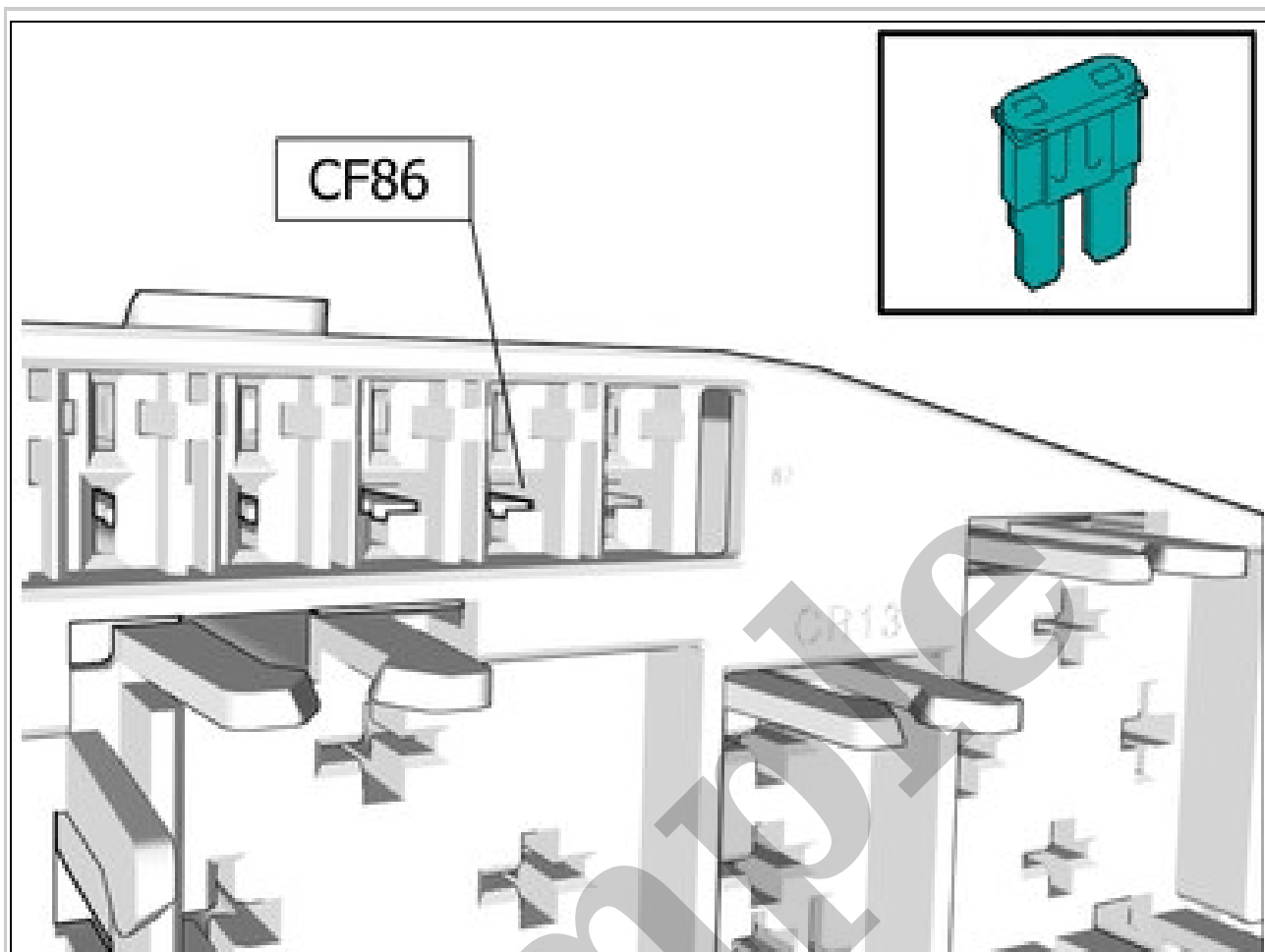

Courtesy of VOLVO CARS CORPORATION

Install component that comes with the accessory kit.