

# Your Ultimate Source for OEM Repair Manuals

FactoryManuals.net is a great resource for anyone who wants to save money on repairs by doing their own work. The manuals provide detailed instructions and diagrams that make it easy to understand how to fix a vehicle.

## 1980 VOLVO 66 OEM Service and Repair Workshop Manual

[Go to manual page](#)

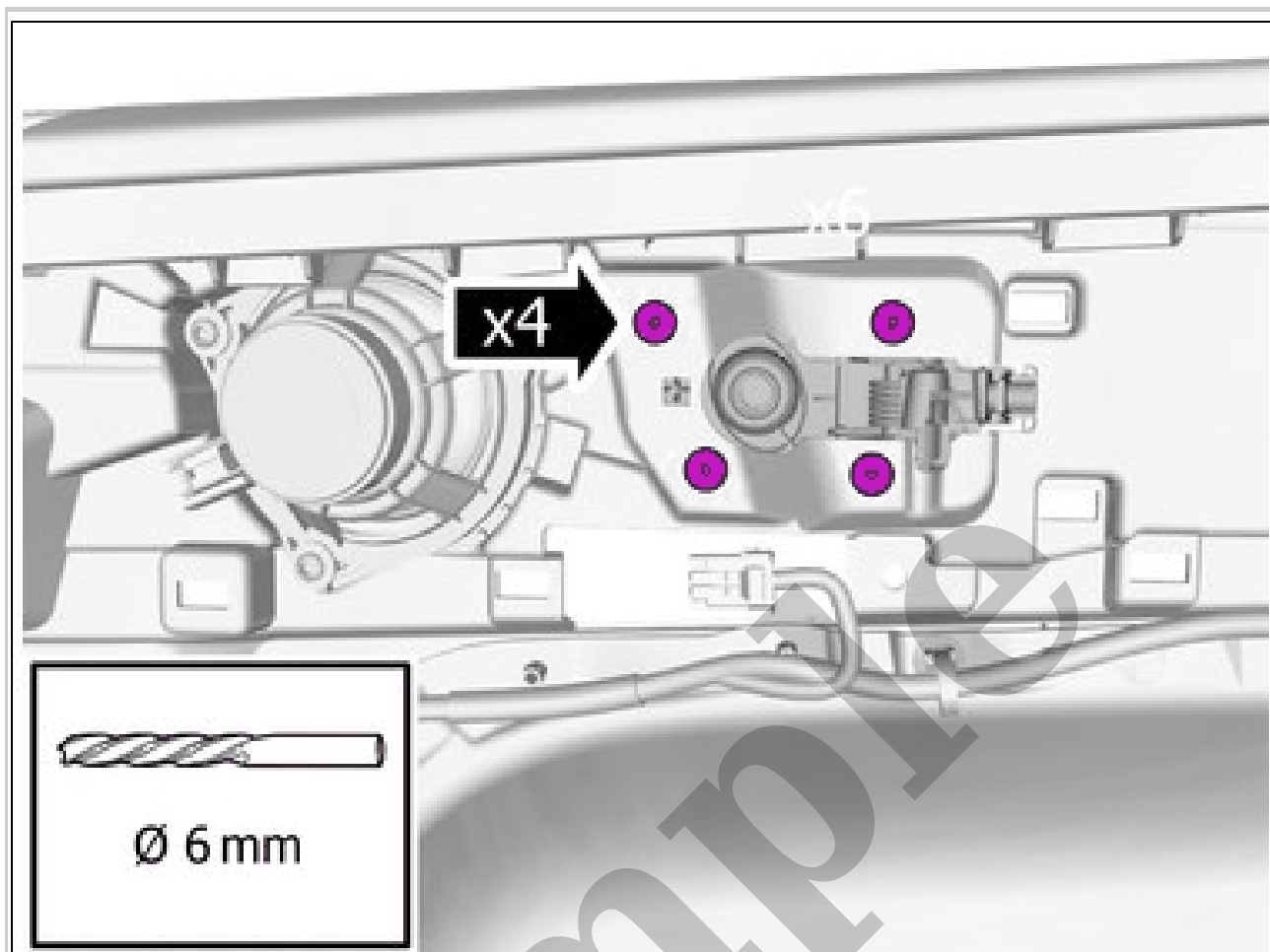

Courtesy of VOLVO CARS CORPORATION

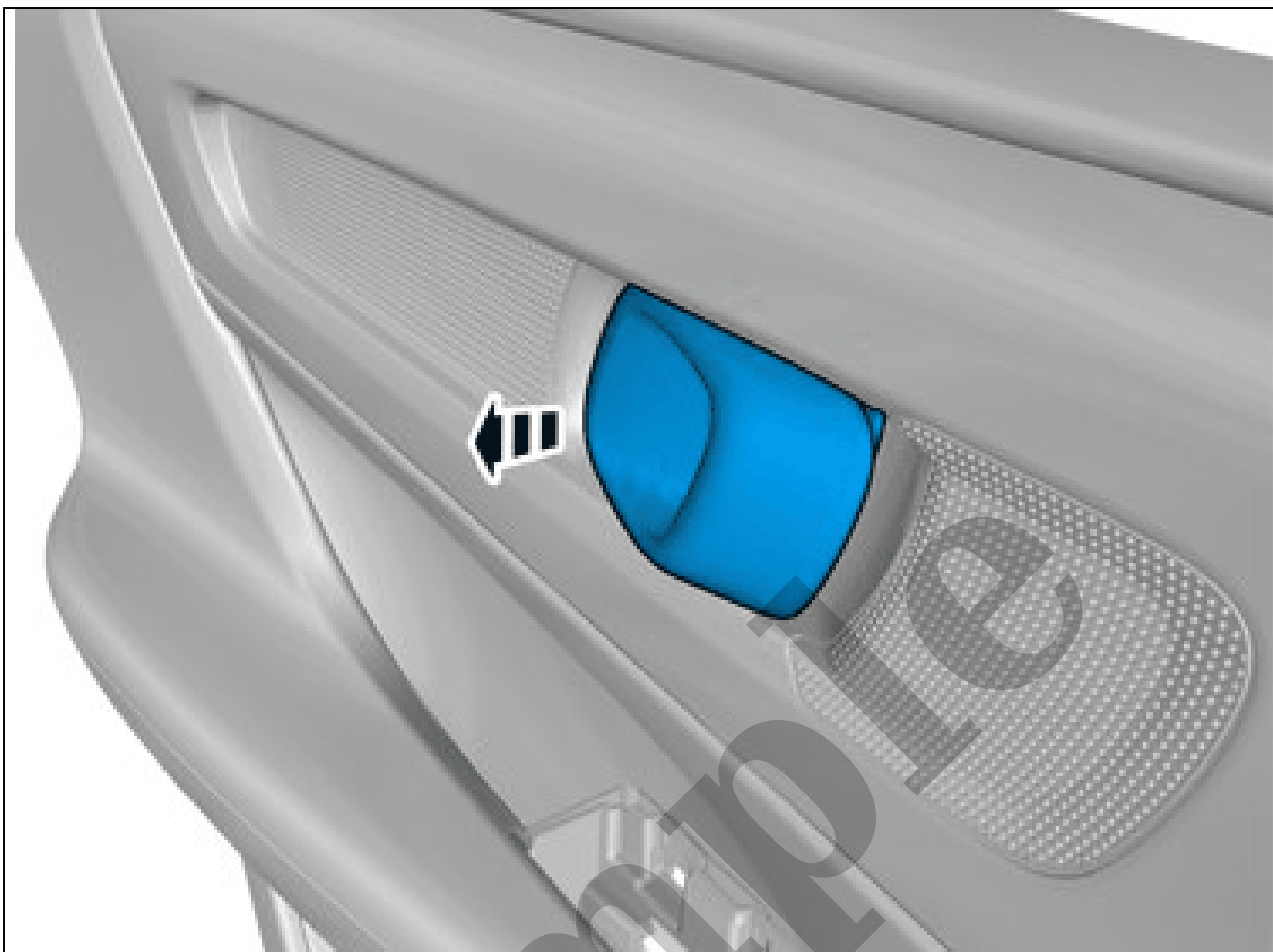

Courtesy of VOLVO CARS CORPORATION

Remove the marked part.  
The part is not to be reused.

**HANDLE INTERNAL, DOOR REAR > HANDLE INTERNAL, DOOR REAR [2018-2022] >  
INSTALLATION**



Courtesy of VOLVO CARS CORPORATION

Disconnect the connector.  
Remove the marked part.

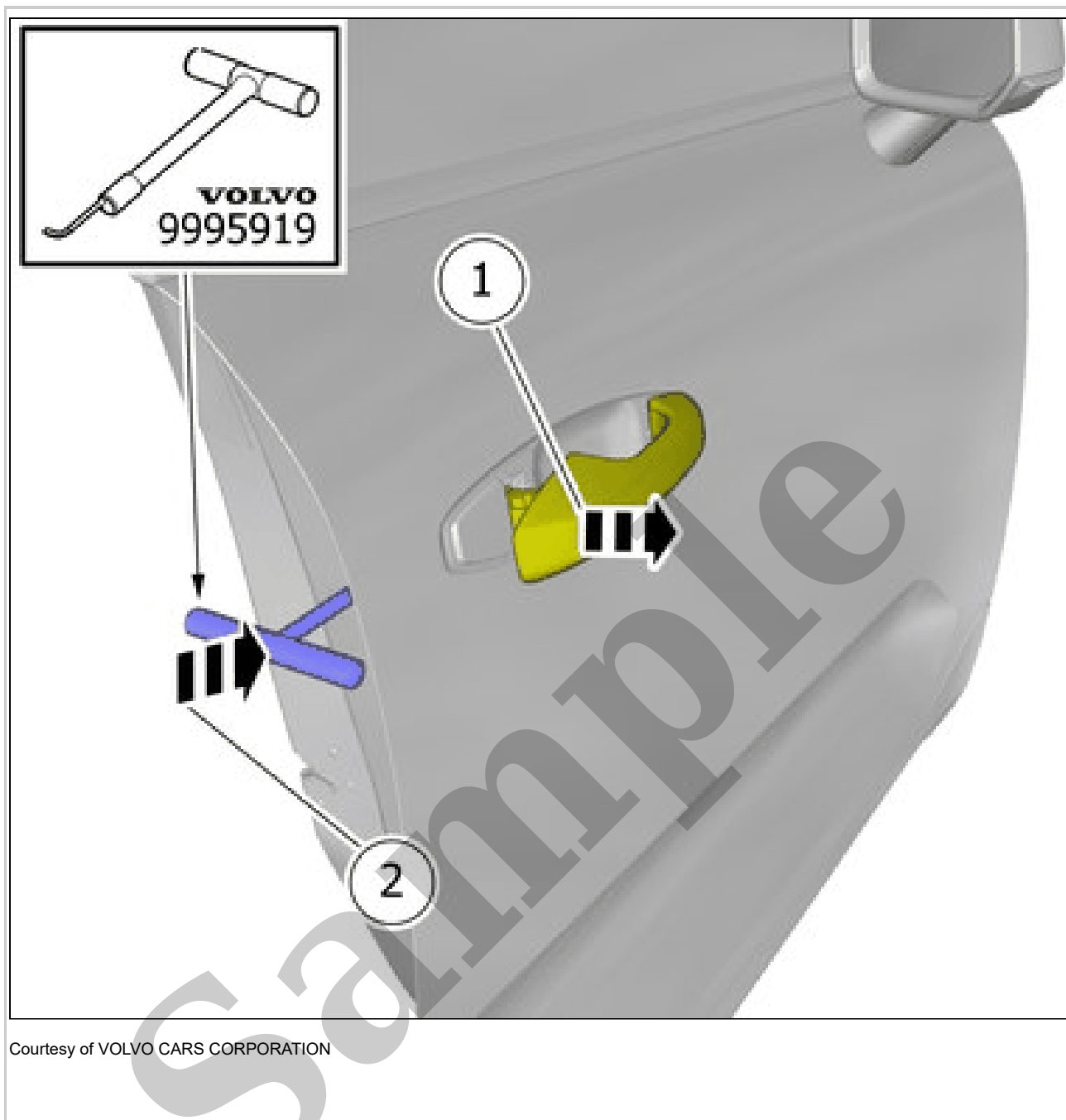

**CAUTION:** Pull the door handle outwards and hold it in the pulled out position.

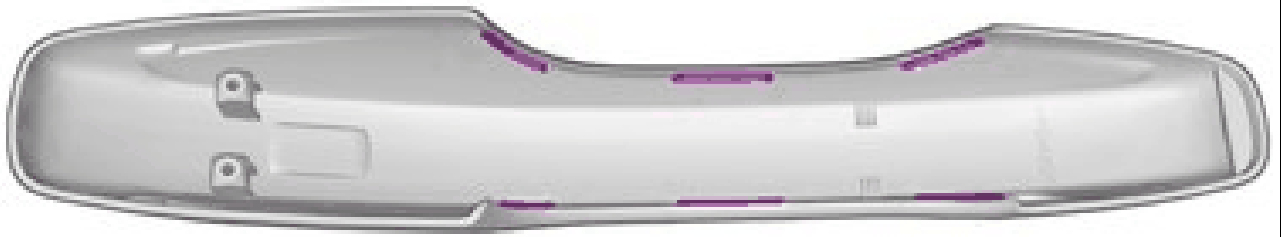

Courtesy of VOLVO CARS CORPORATION

The graphic shows the back of the component.

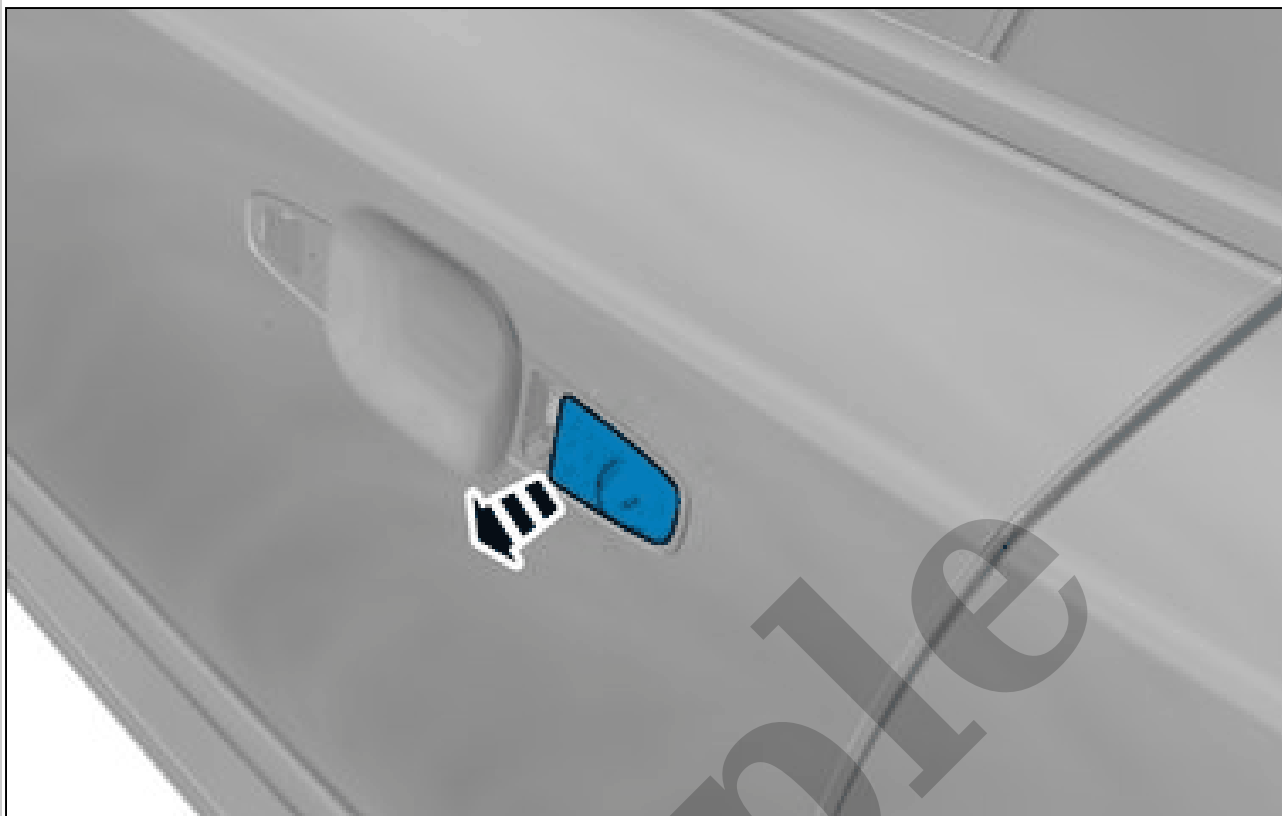

Courtesy of VOLVO CARS CORPORATION

Remove the marked part.

### **LOCK CYLINDER, DOOR > LOCK CYLINDER, DOOR [2018-2022] > INSTALLATION**

To install, reverse the removal procedure.

### **LOCK MOTOR TAILGATE > LOCK MOTOR TAILGATE [2018-2022] > REMOVAL**

Perform lock mechanism boot lid. Refer to: TRUNK LID/TAILGATE LOCK MECHANISM

### **OUTER HANDLE, REAR DOOR > OUTER HANDLE, REAR DOOR [2018-2022] > REMOVAL AND INSTALLATION**

#### **REMOVAL**

Set the vehicle to Inactive mode, described in user mode. Refer to: USAGE MODE



Courtesy of VOLVO CARS CORPORATION

Remove the screws.



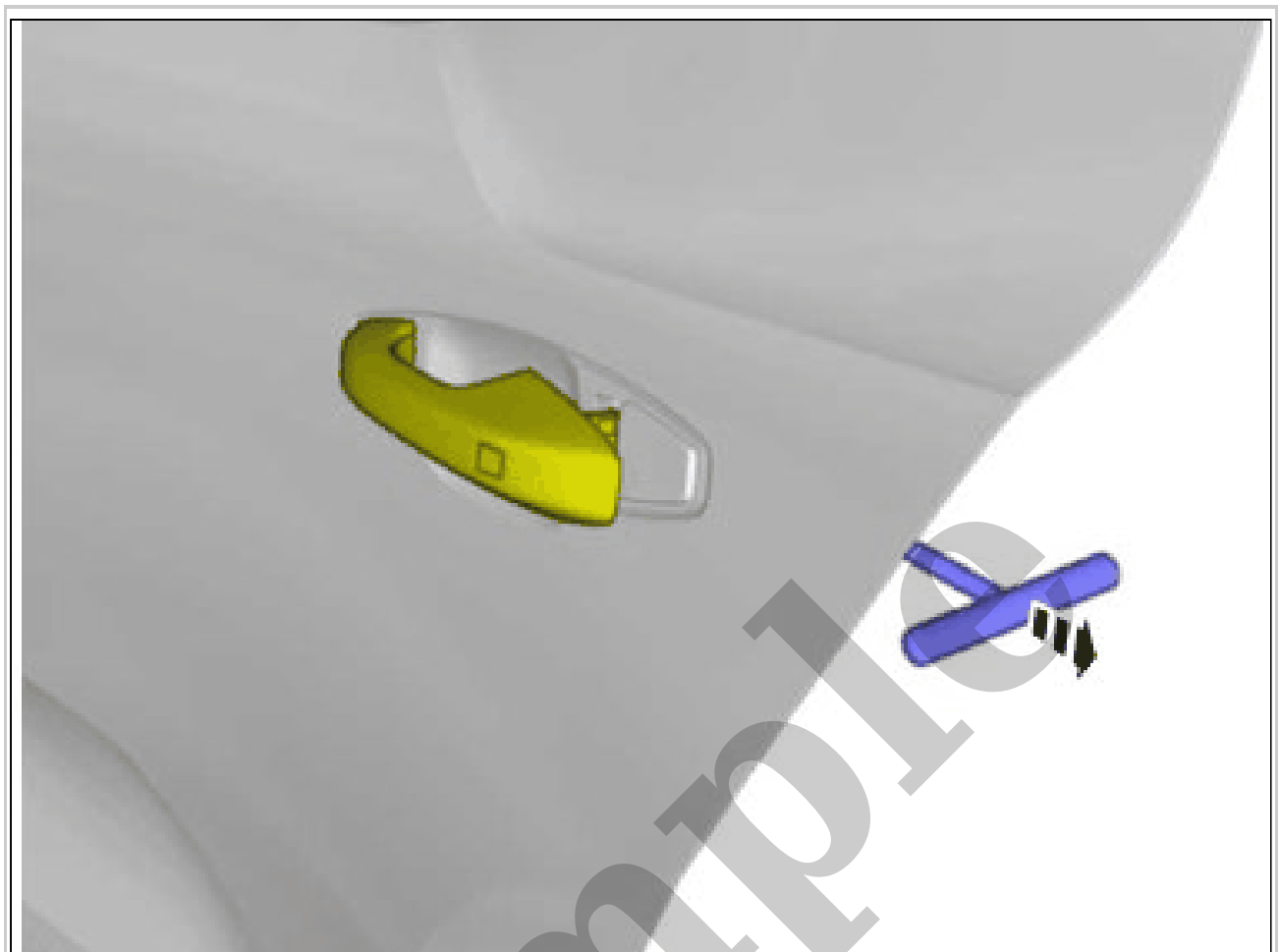

Courtesy of VOLVO CARS CORPORATION

**CAUTION:** *Do not hold the door handle when the locking is released.*

Release the lock.

## **OUTER TAILGATE/TRUNK LID HANDLE > OUTER TAILGATE/TRUNK LID HANDLE [2018-2022] > REMOVAL AND INSTALLATION**

### **REMOVAL**

**NOTE:** *Removal steps in this procedure may contain installation details.*

Set the vehicle to Inactive mode, described in user mode. Refer to: USAGE MODE

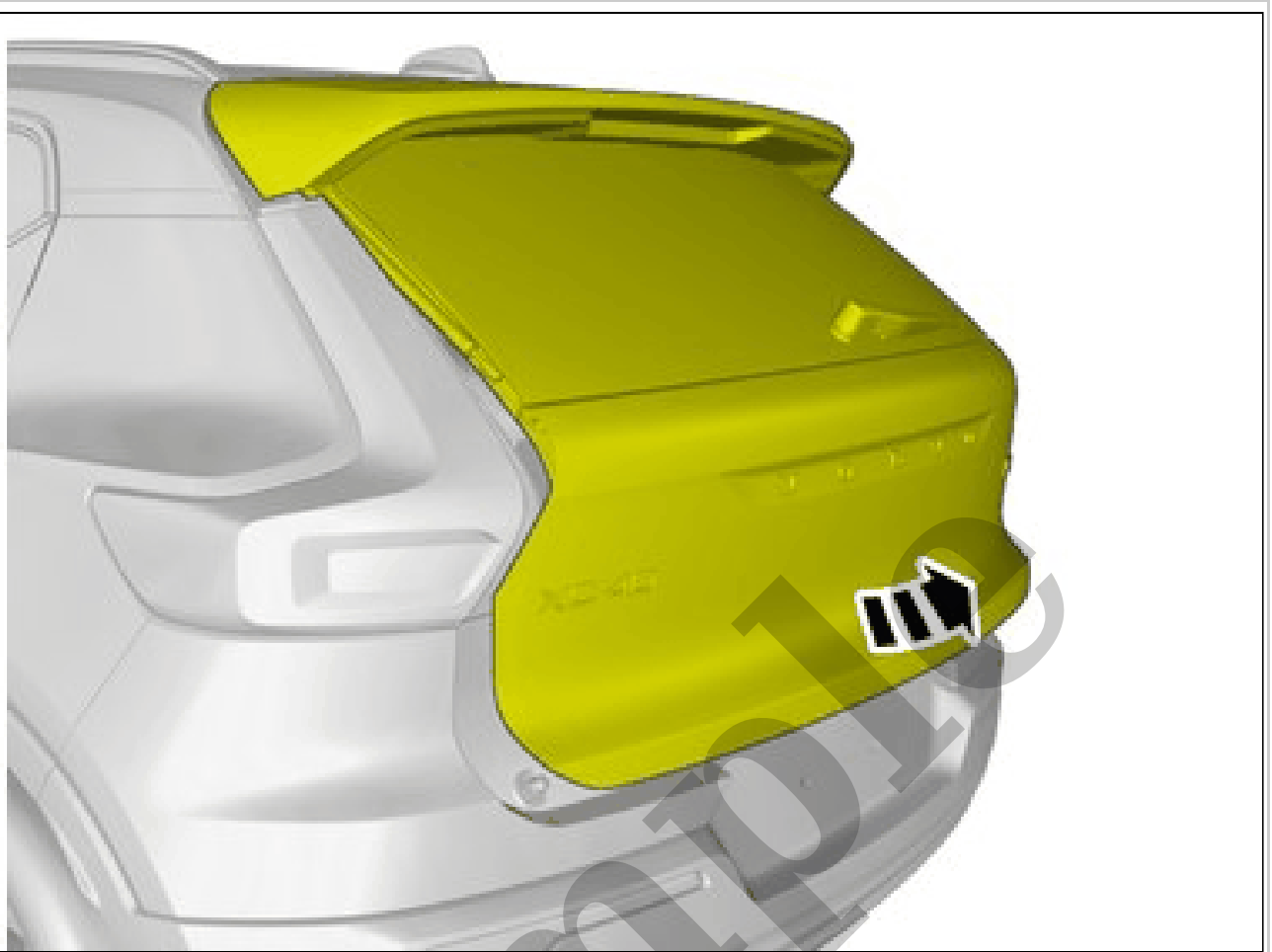

Courtesy of VOLVO CARS CORPORATION

Set the vehicle to Inactive mode, described in user mode. Refer to: USAGE MODE  
Remove the tailgate/trunk lid trim panel. Refer to: TAILGATE/TRUNK LID PANEL